

Adapter Roof VW Crafter 2017

➤ Instructions

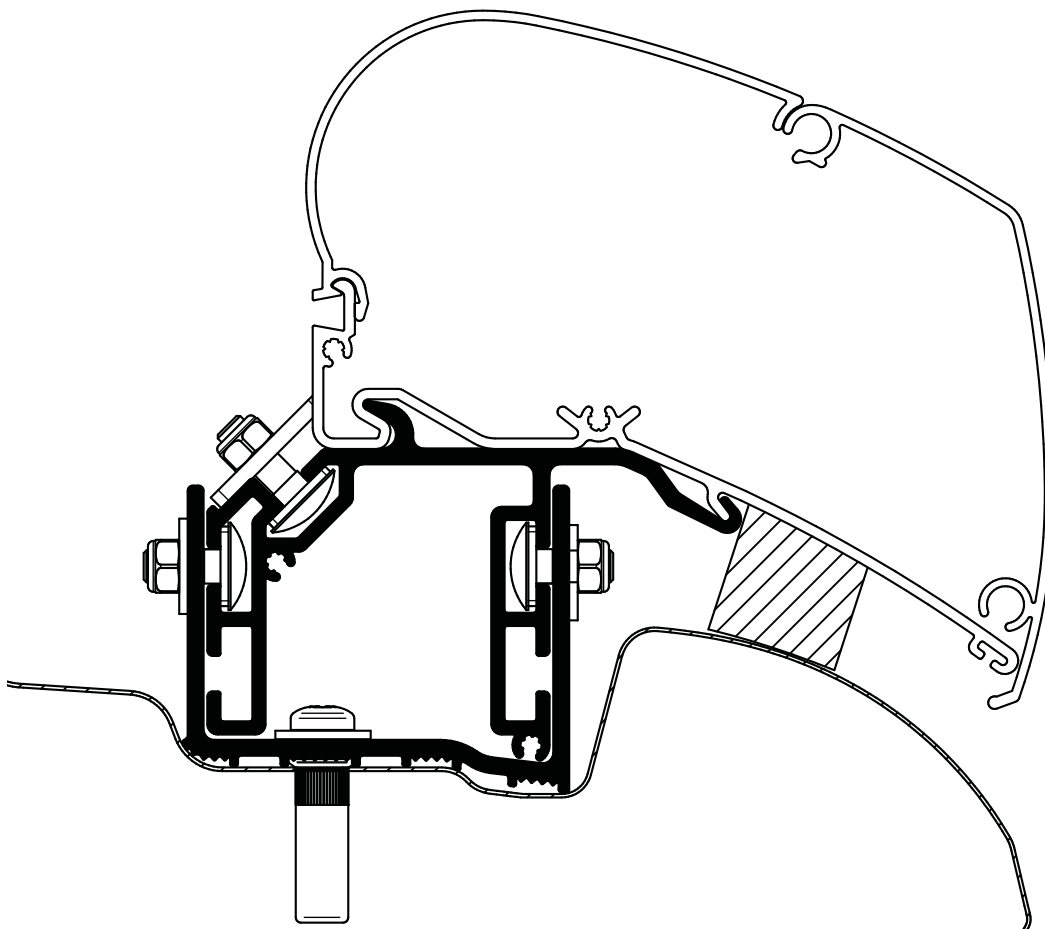

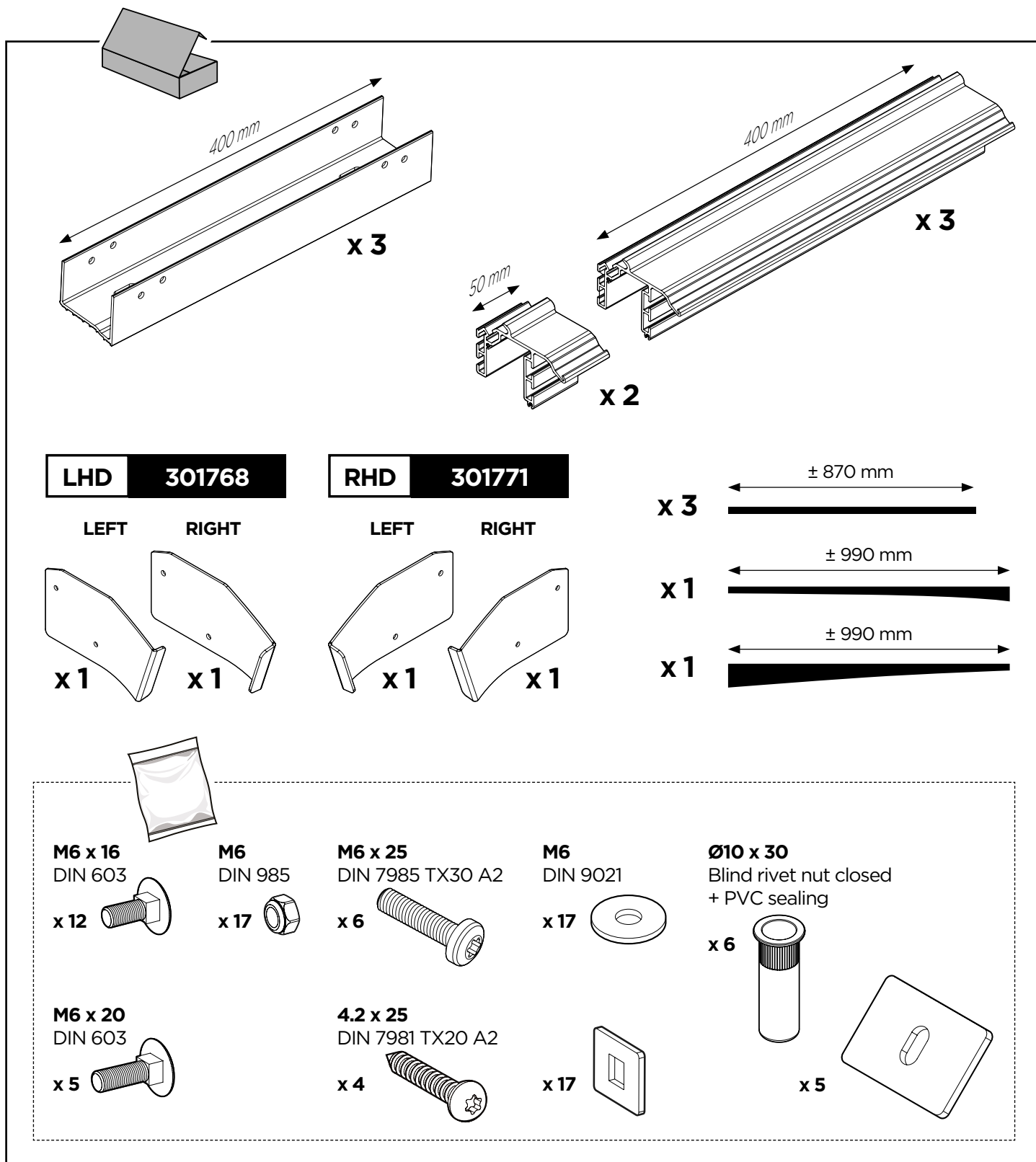
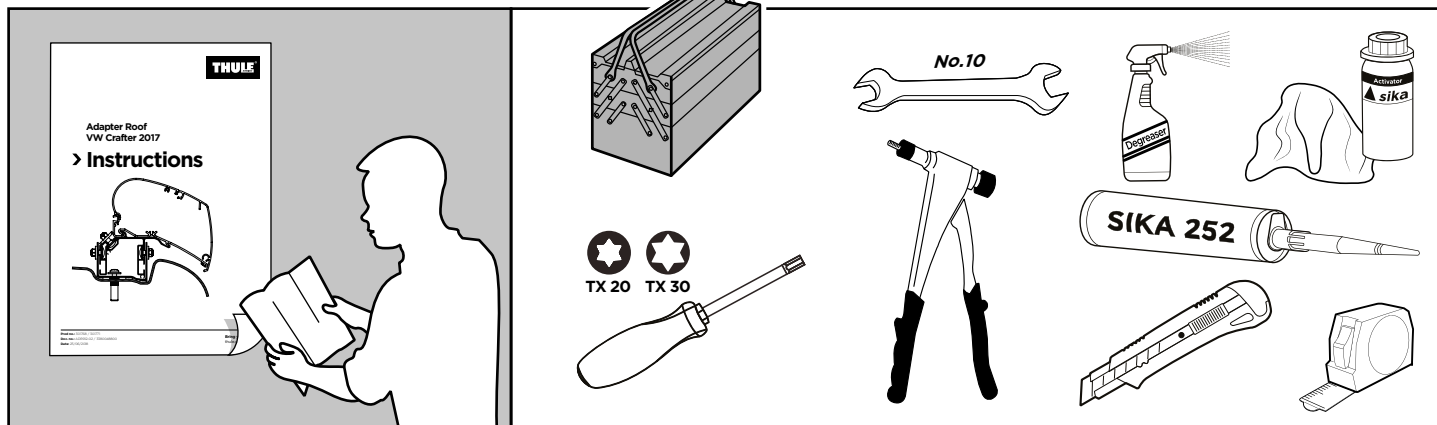

i

RIGHT HAND DRIVE (RHD) is **MIRROR** of LEFT HAND DRIVE (LHD)

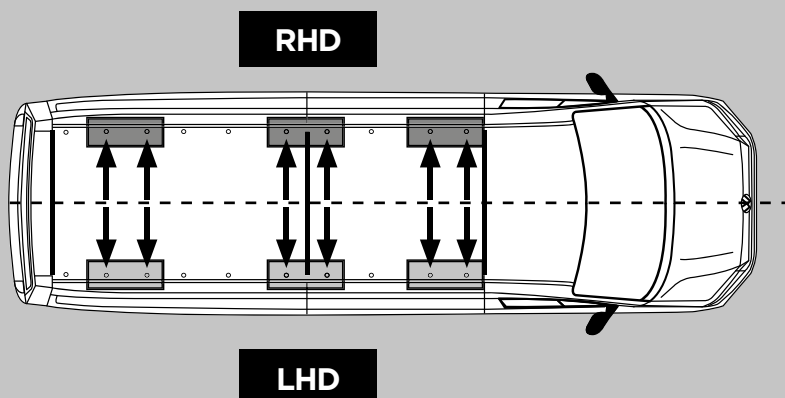
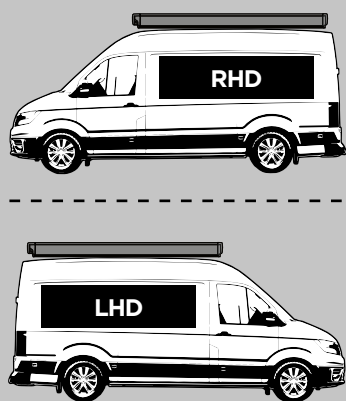

! IN THIS MANUAL **LEFT HAND DRIVE (LHD)** IS SHOWN BY **DEFAULT**

L3H3

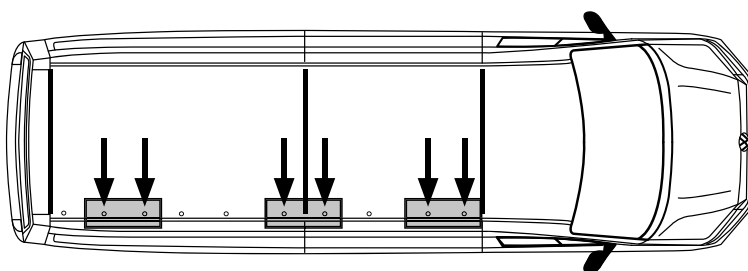
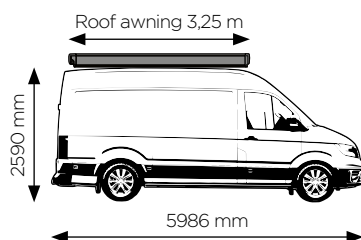

use **6/10** roof fixation points

L4H3

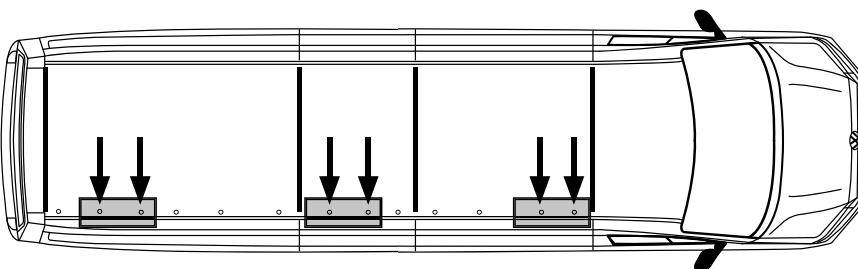
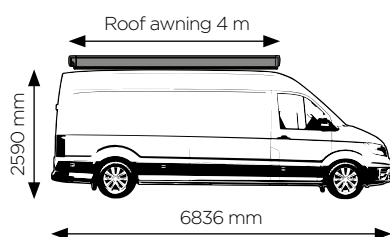

use **6/13** roof fixation points

L5H3

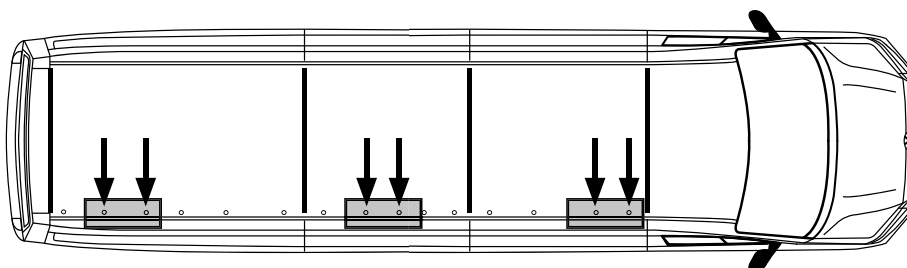
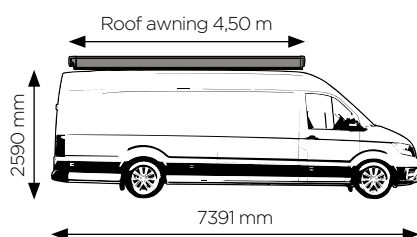

use **6/15** roof fixation points

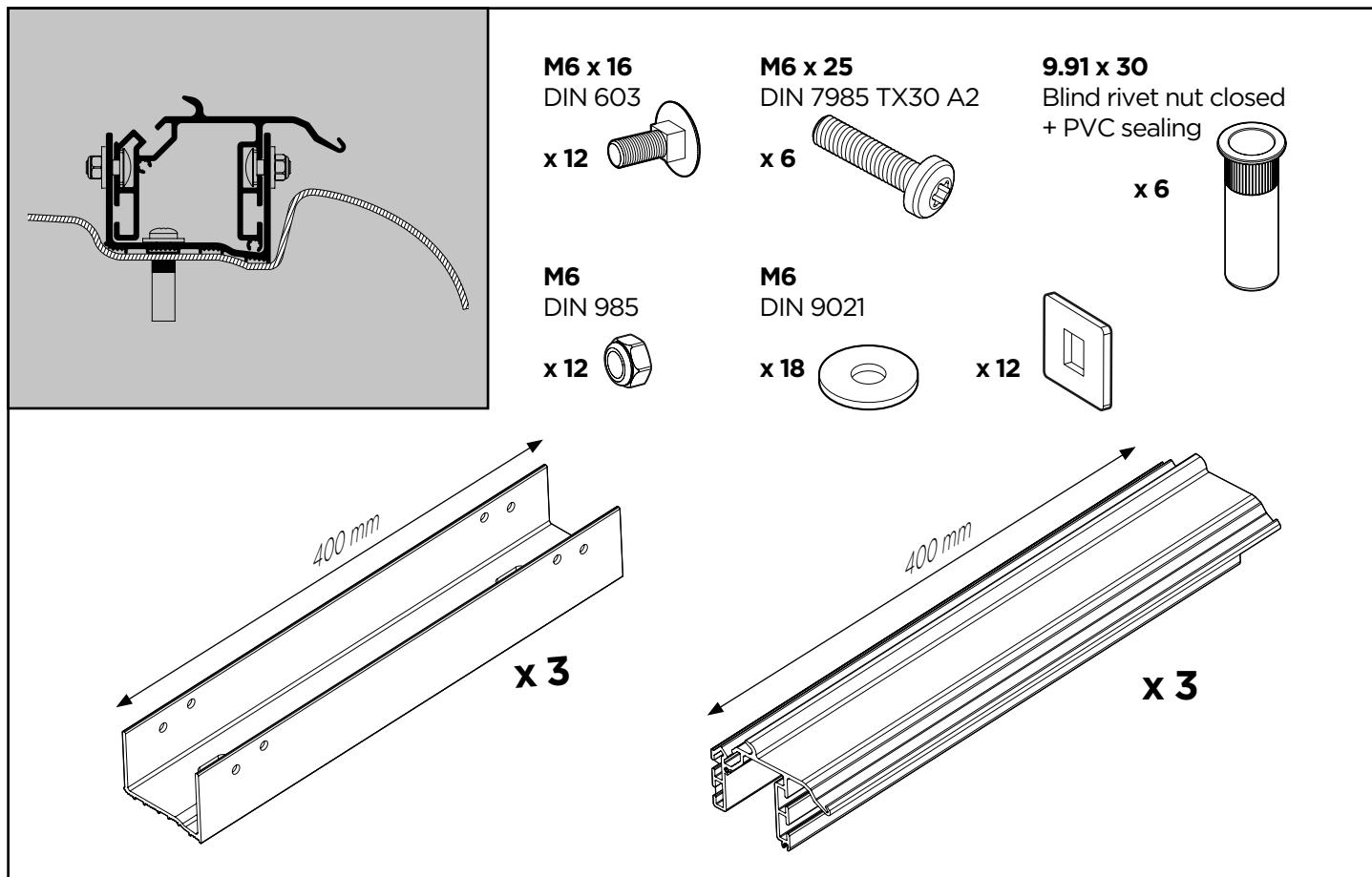

1 Remove protection of the 6 adapter fixation points

L4H3

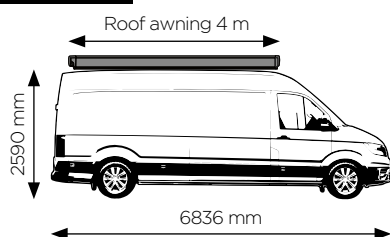

! RHD IS MIRROR OF LHD

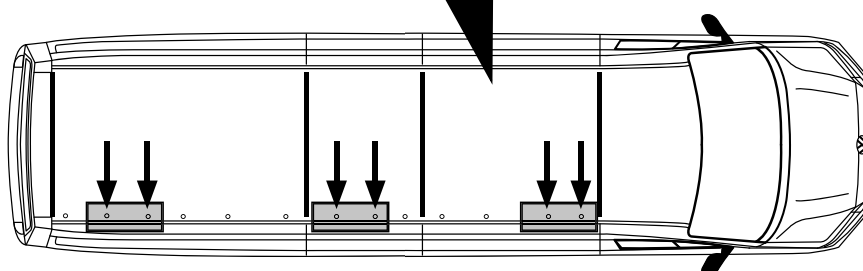

L3H3 p3

L5H3 p3

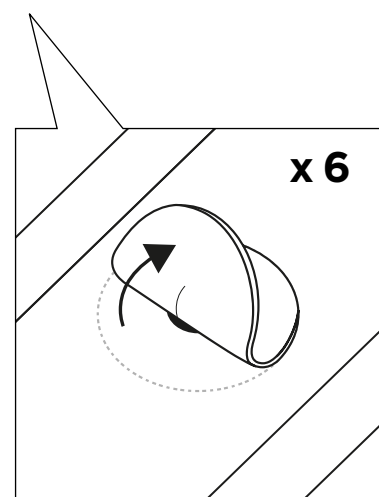
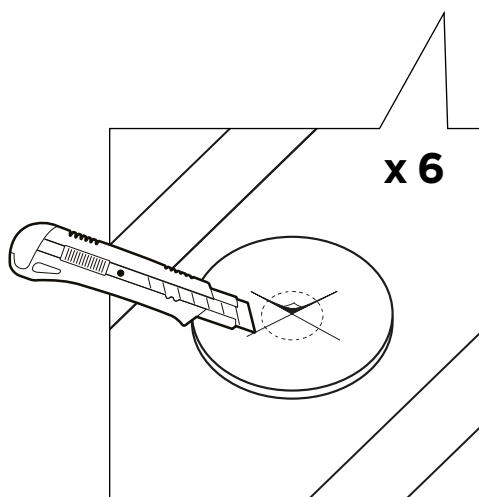

2 Degrease the roof

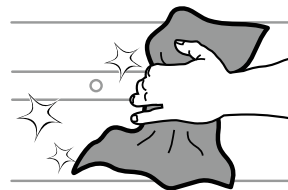
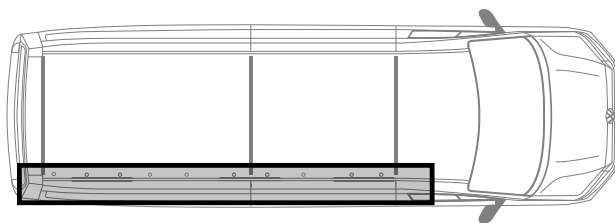
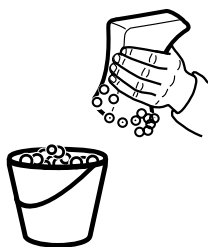

3 Assemble the blind rivet nuts

! RHD IS MIRROR OF LHD

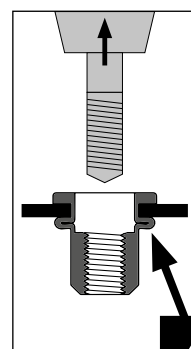
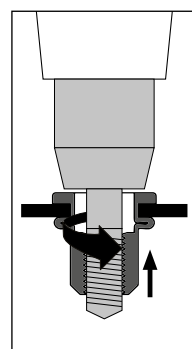
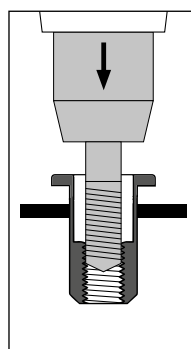
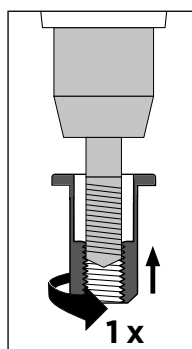
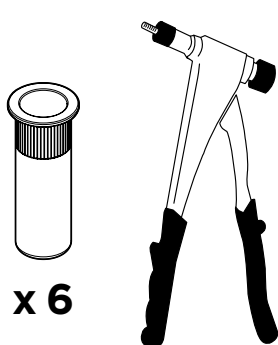

x 3

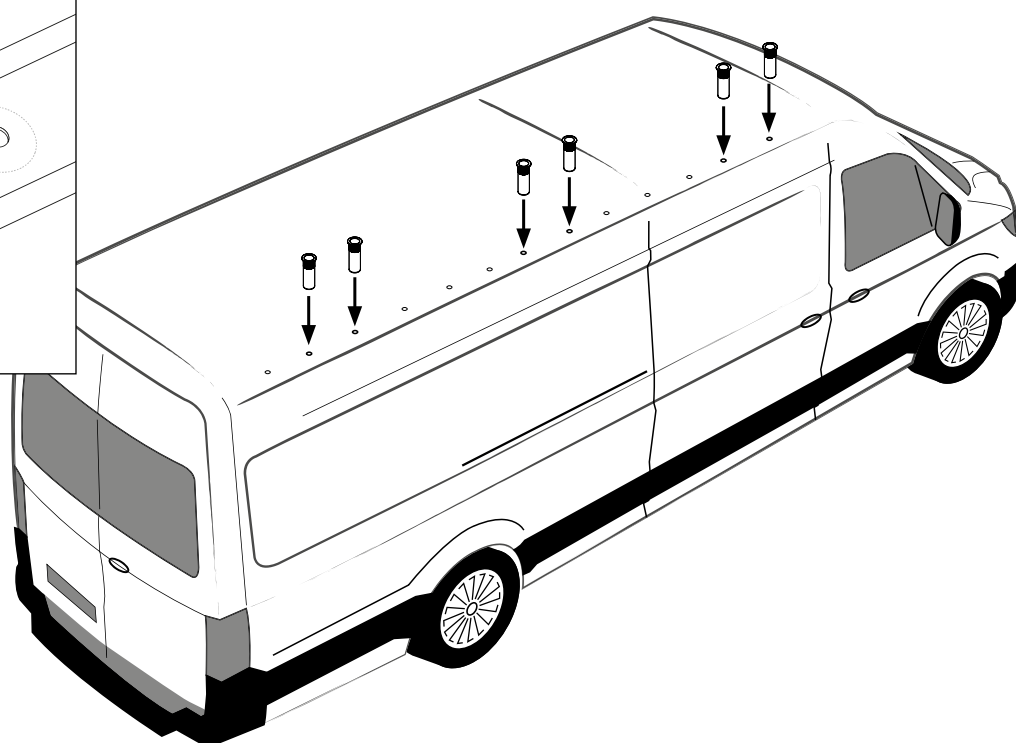
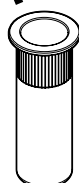
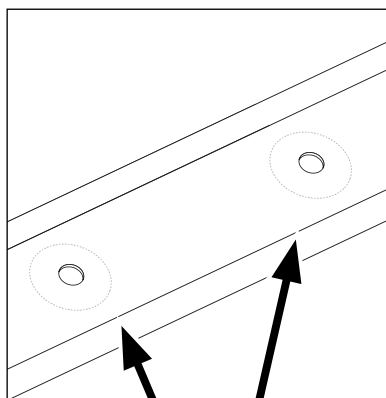

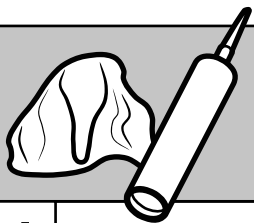

Glue / Lijmen / Verklebung:

Thule recommends / beveelt aan / empfiehlt: **SIKA 252 or Terostat MS937**

Primern und Abdichtung nach Anweisung des Dichtmittelherstellers.

Voorbehandeling en afdichting volgens de voorschriften van de lijmfabrikant.

Preparation and sealing according to the prescripts of the glue supplier.

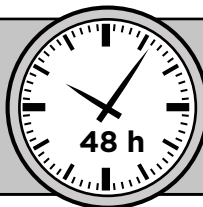

4 Gluing

A

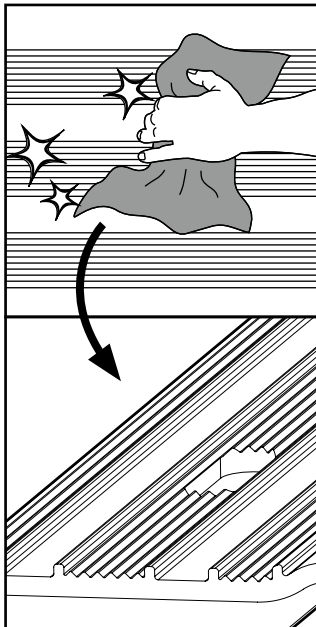

B

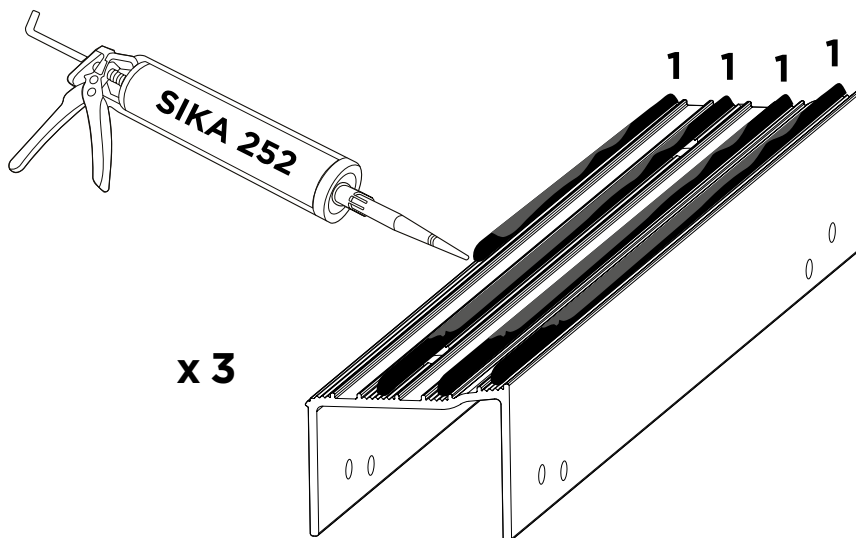

5 Mounting the base on the roof

! RHD IS MIRROR OF LHD

M6 x 25
DIN 7985 TX30 A2

x 6

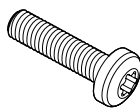

M6
DIN 9021

x 6

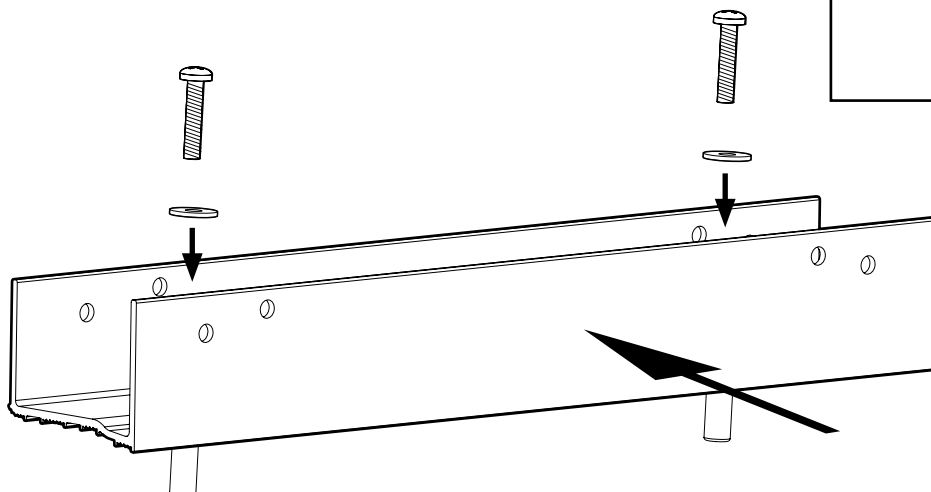
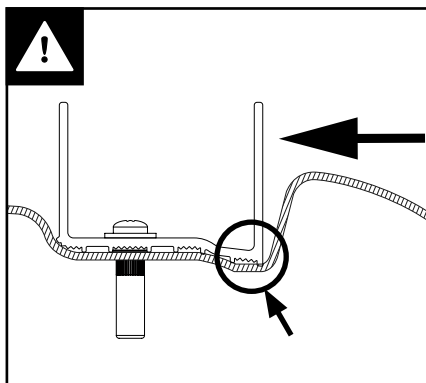
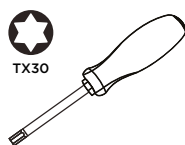

6

Mounting the adapter



RHD IS MIRROR OF LHD

M6 x 16
DIN 603

x 12

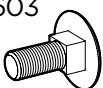

M6
DIN 985

x 12



M6
DIN 9021

x 12

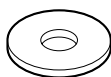

x 12

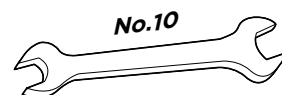

A

BACK

MID

FRONT

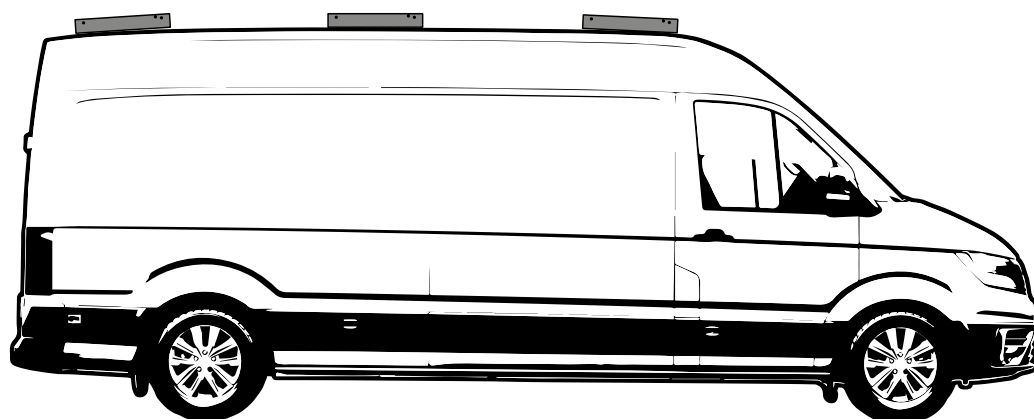
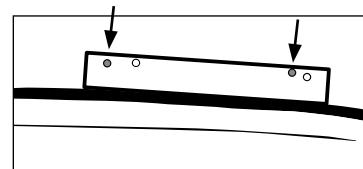
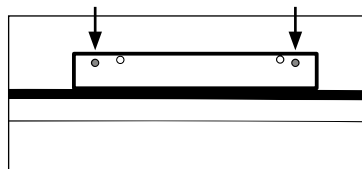
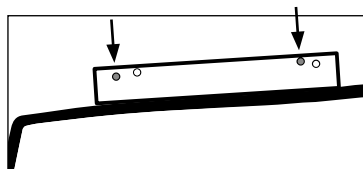

B

BACK

MID

FRONT

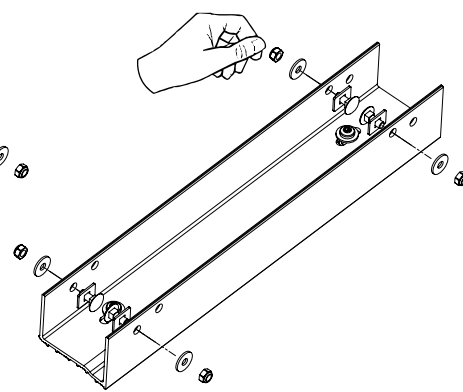
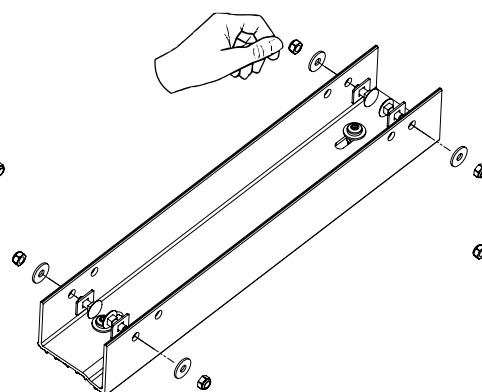
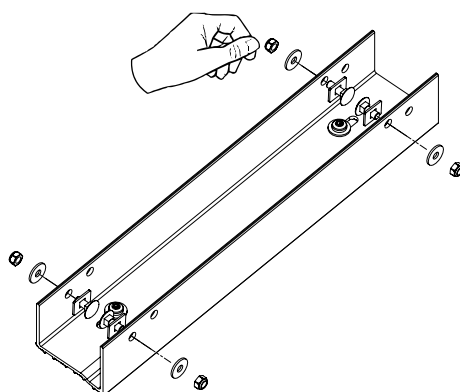
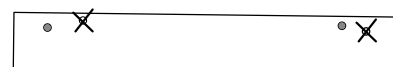

C

BACK

MID

FRONT

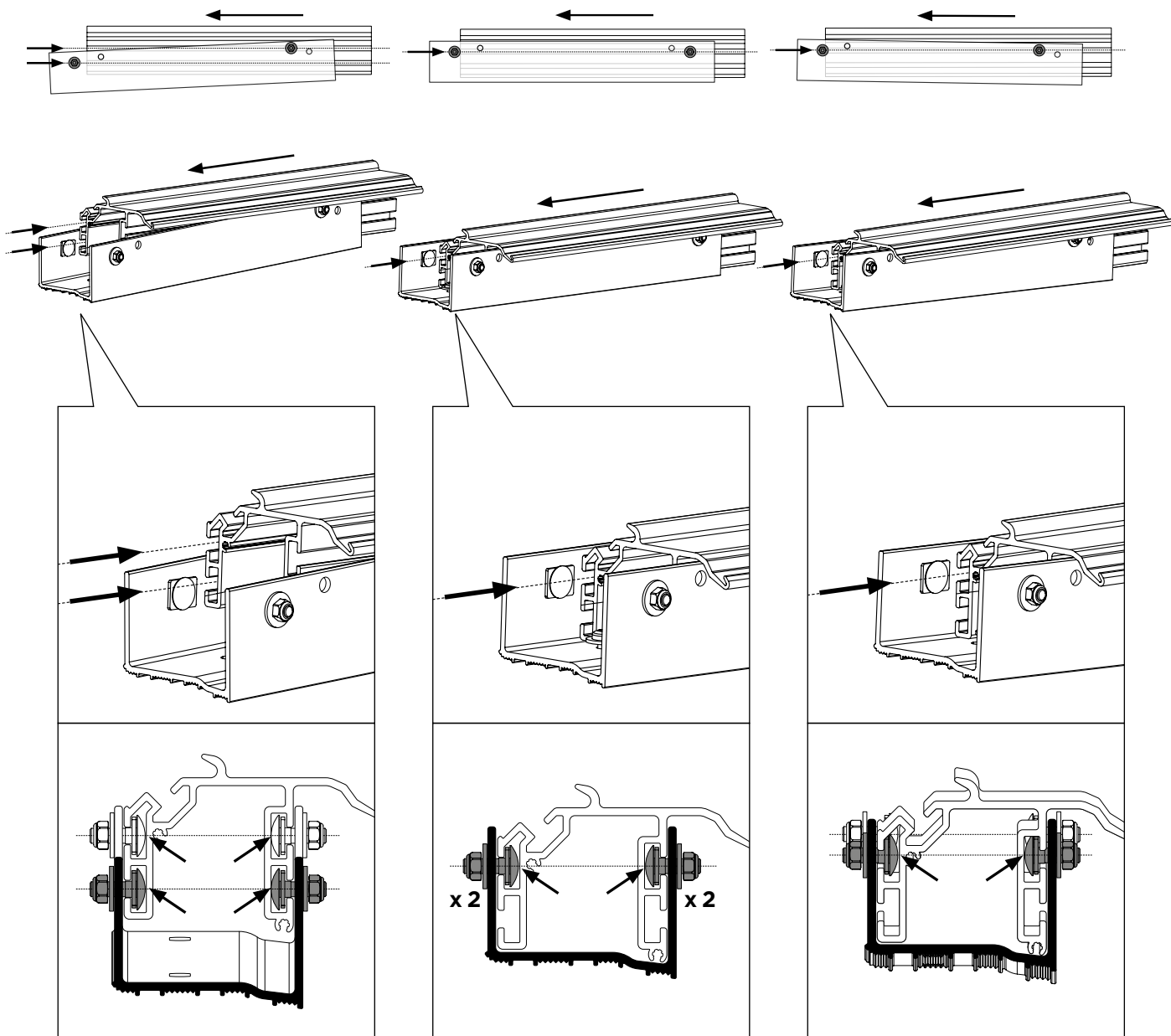

D

BACK

MID

FRONT

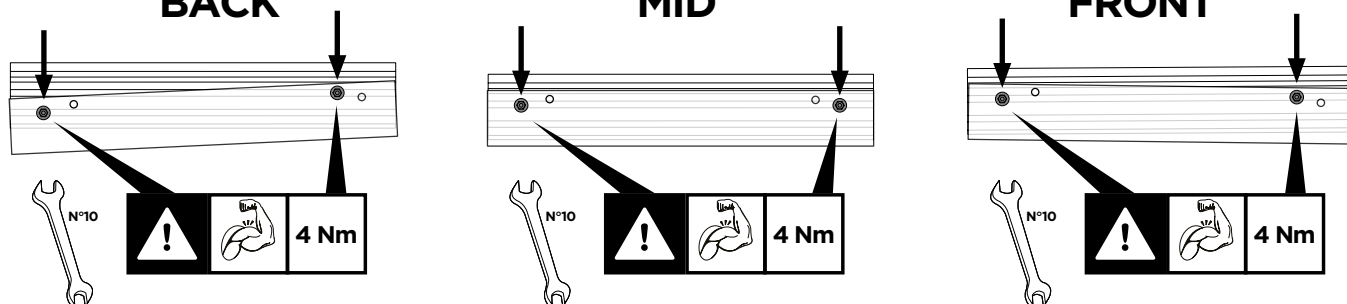

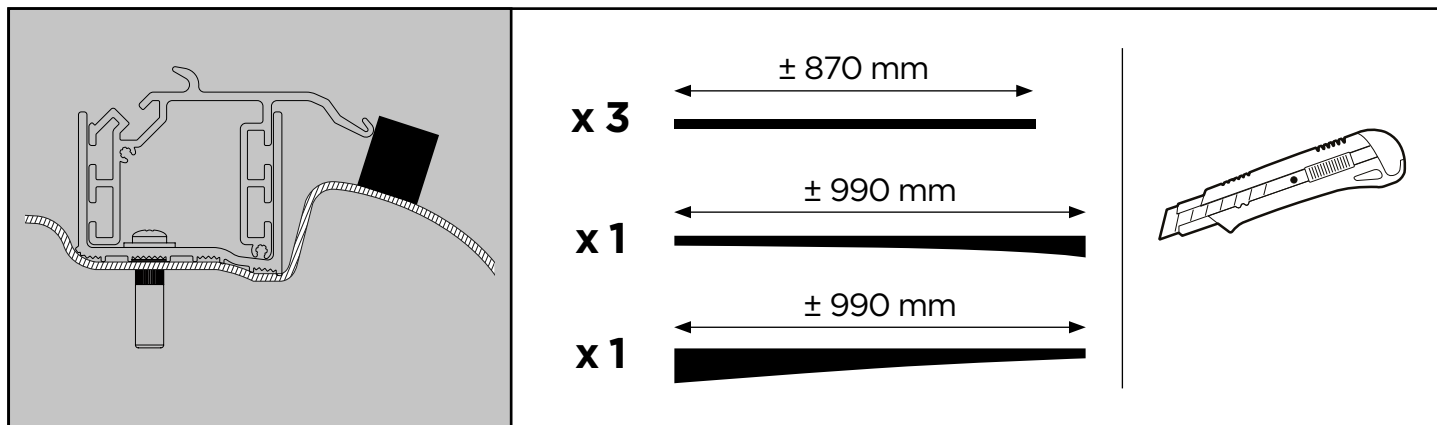

1 Degrease the roof

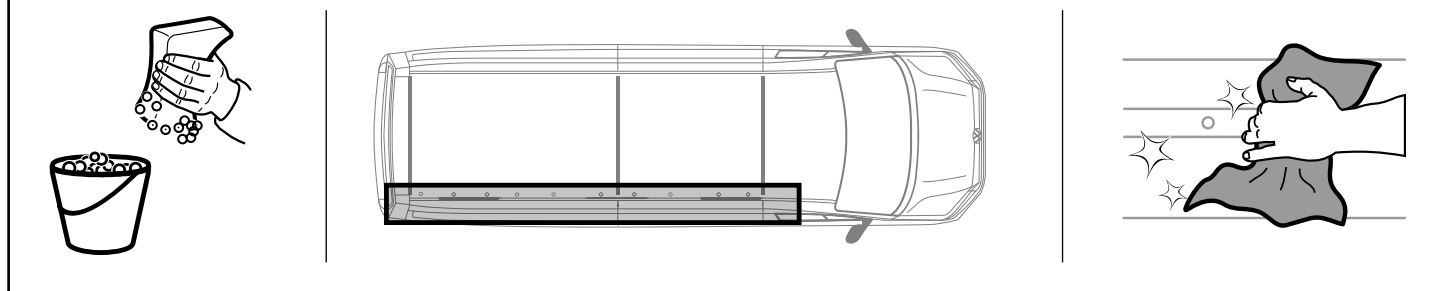

2 Cut the EPDM

! RHD IS MIRROR OF LHD

L3H3

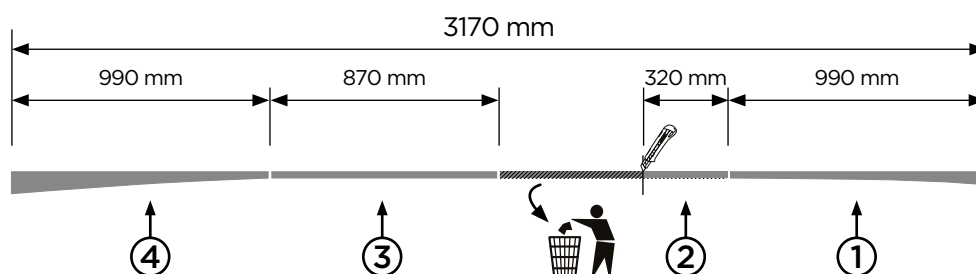

L4H3

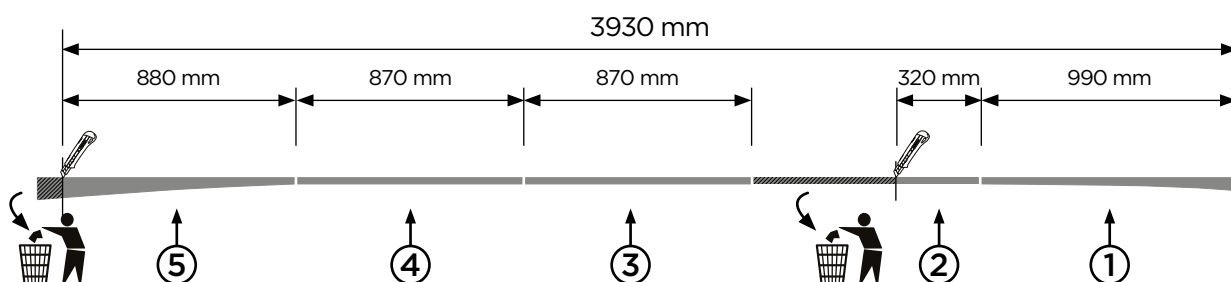

L5H3

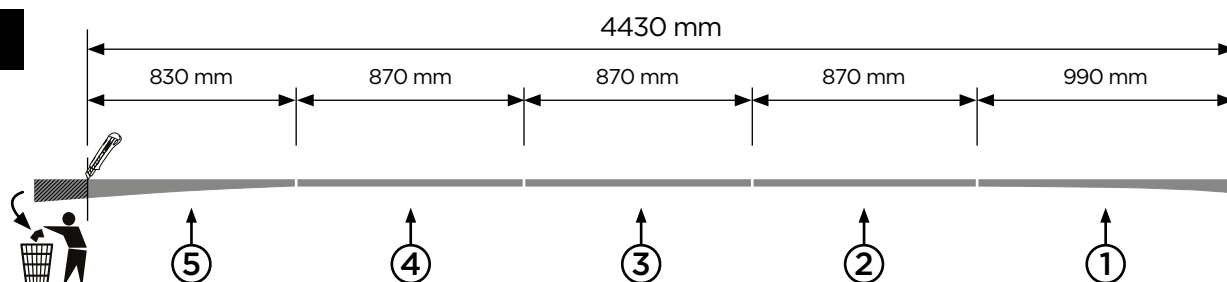

3 Applying the EPDM

! RHD IS MIRROR OF LHD

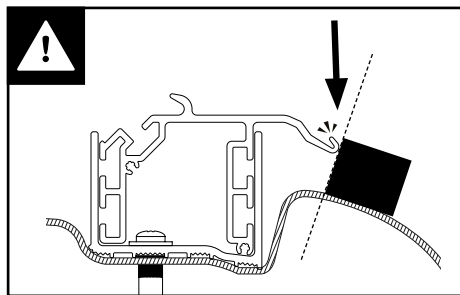
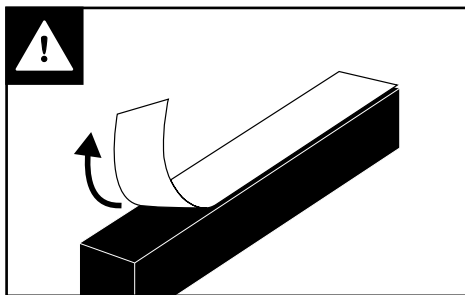

L3H3

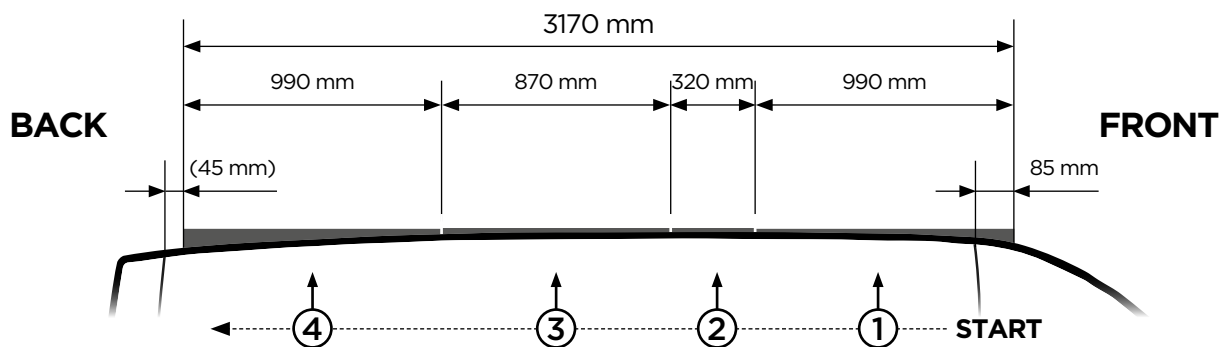

L4H3

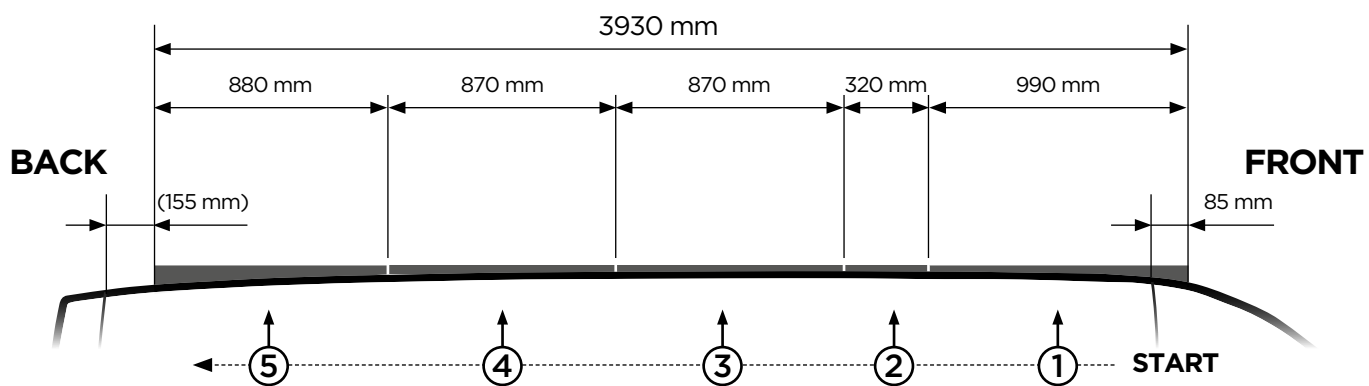

L5H3

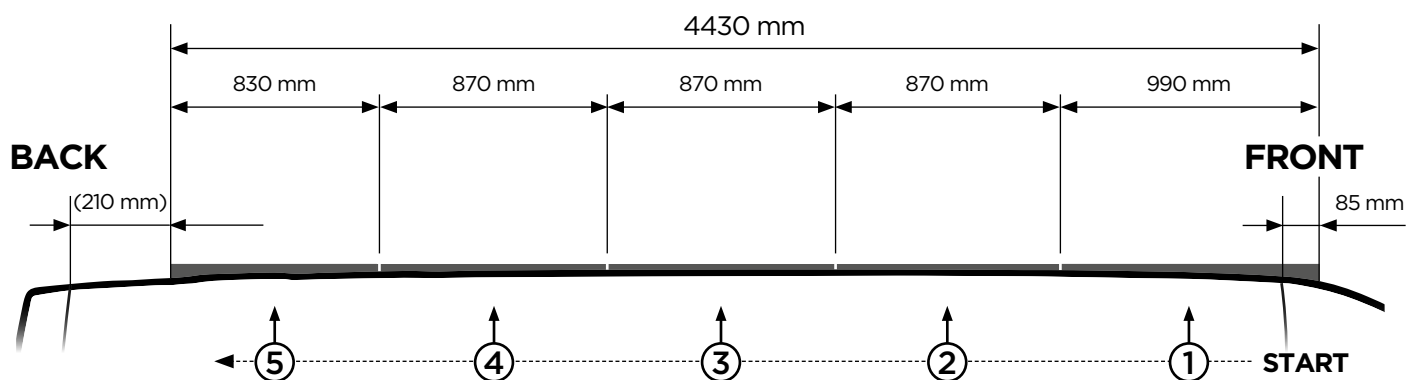

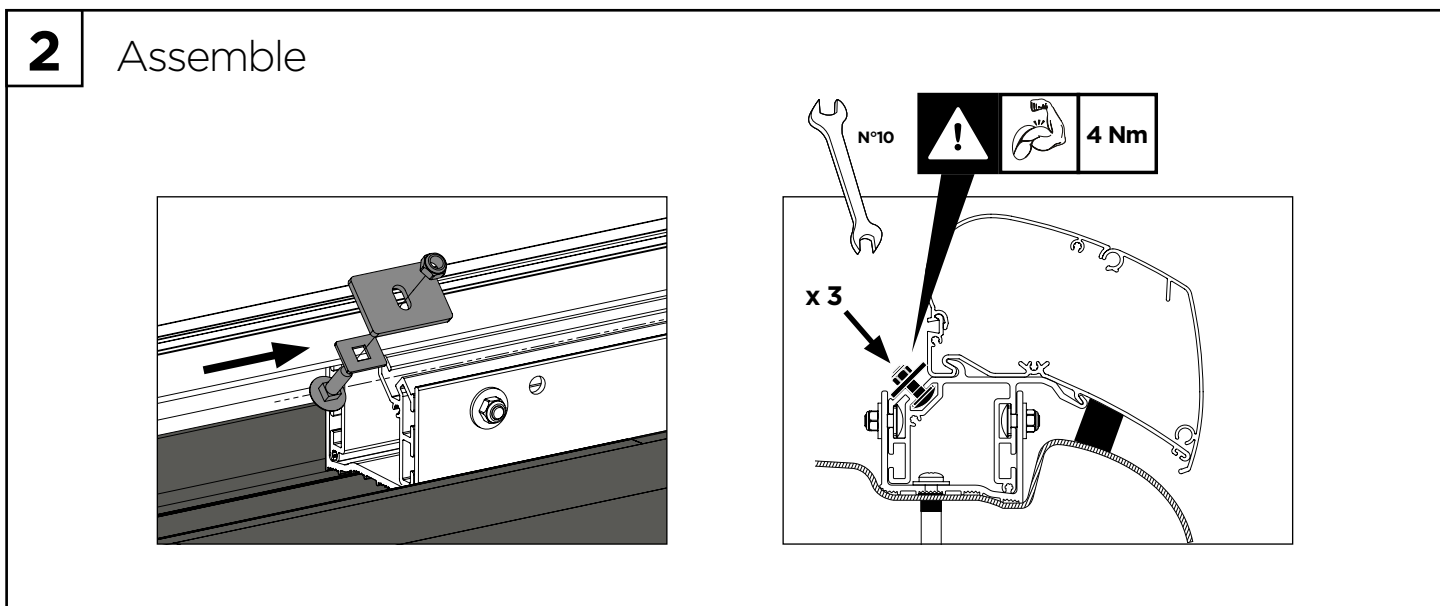
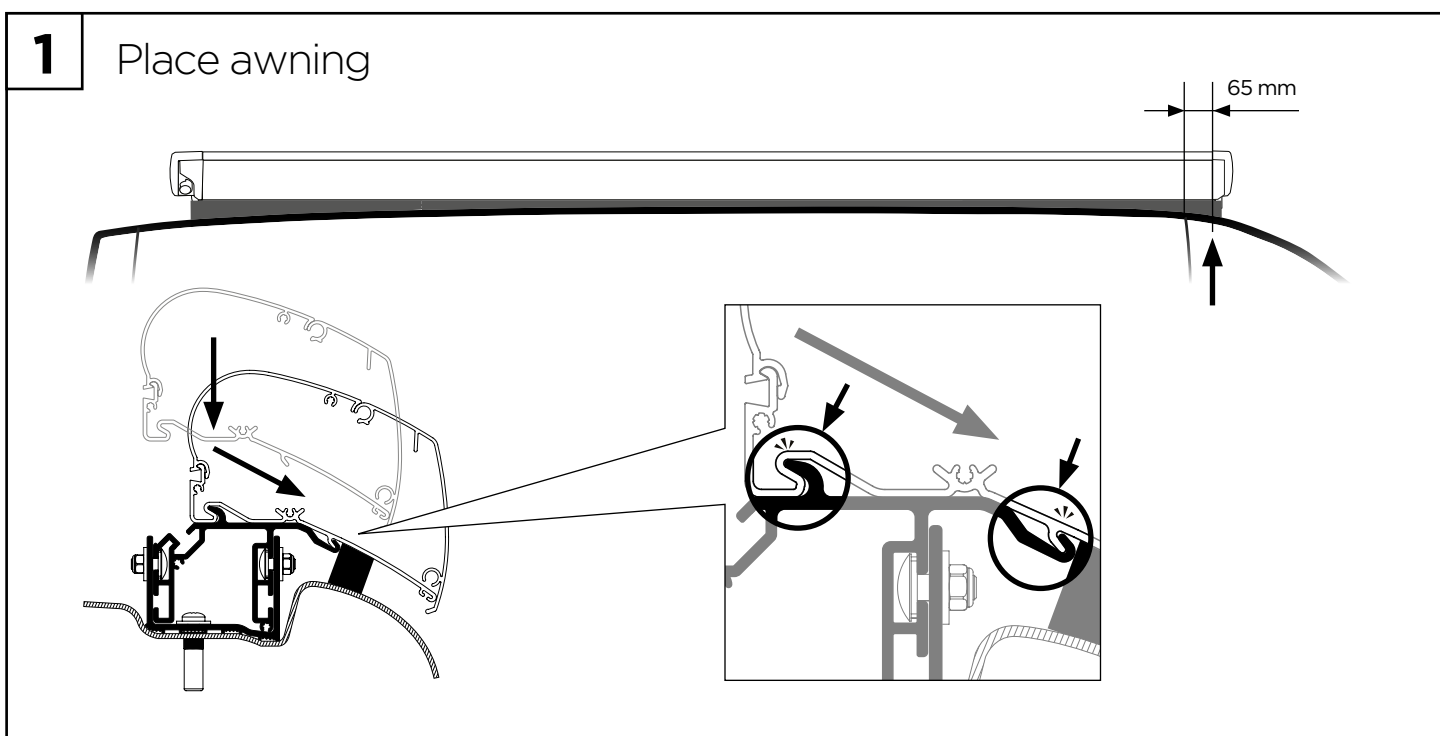
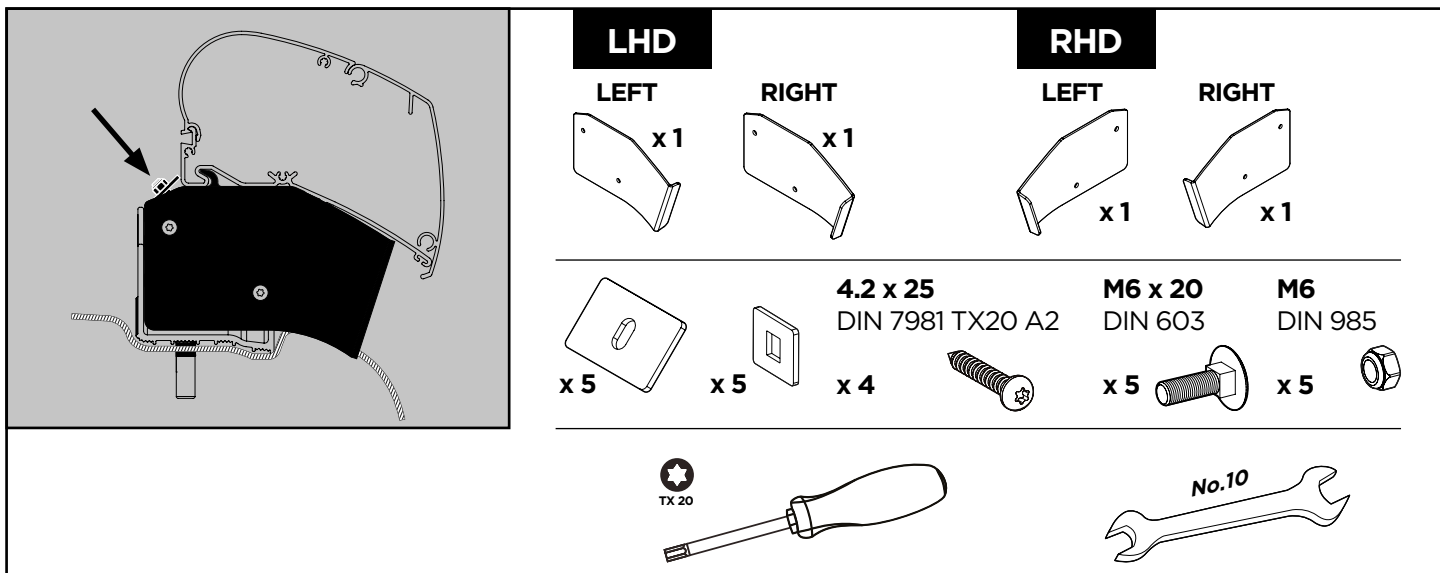

3 Prepare sealing covers (left and right)

! RHD IS MIRROR OF LHD

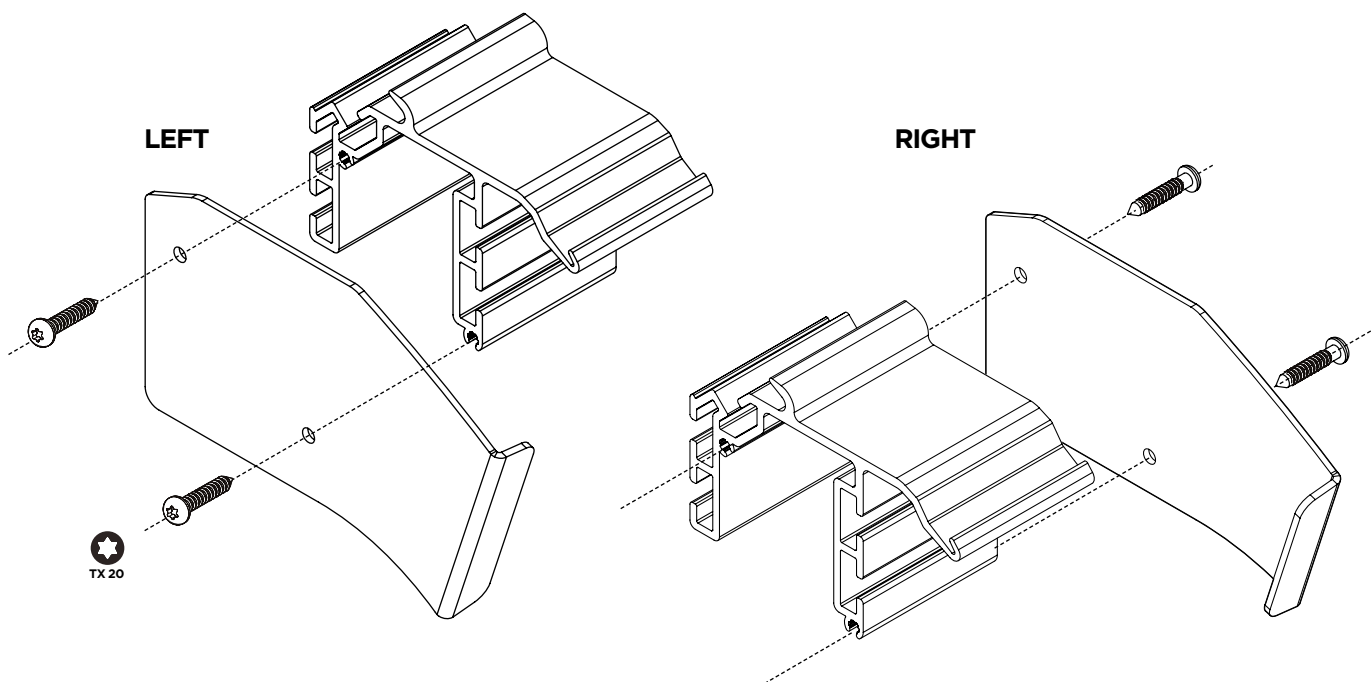

4 Assemble

! RHD IS MIRROR OF LHD

A

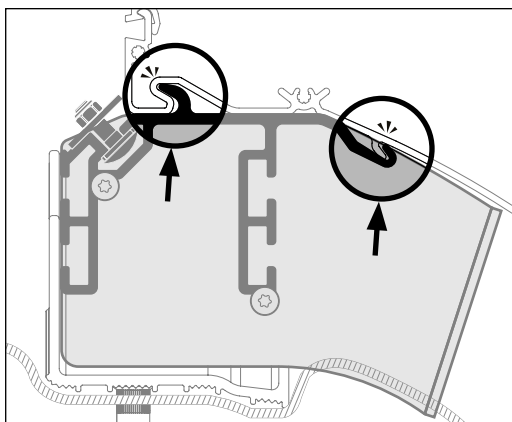

LEFT + RIGHT

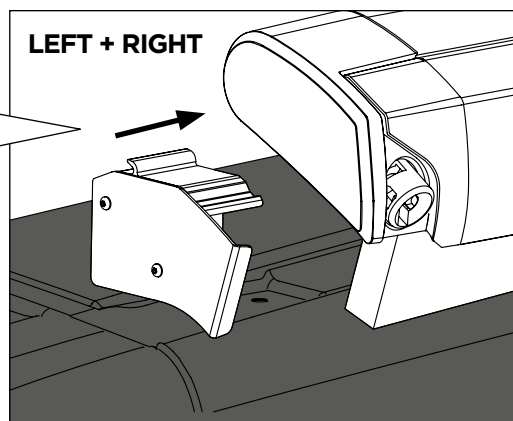

B

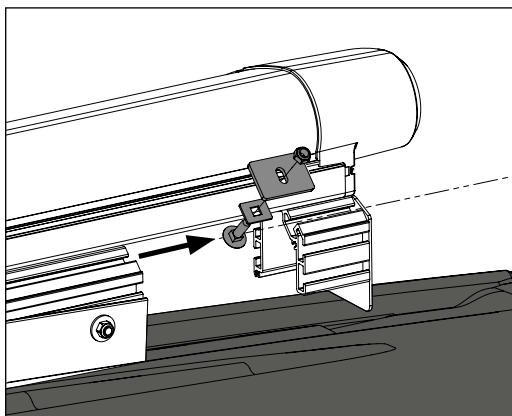

C

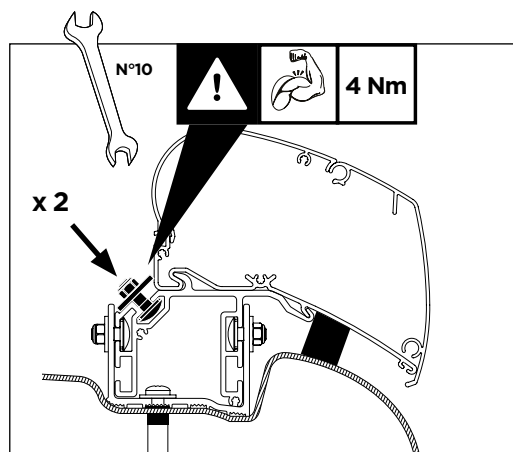

Blank lined paper for writing.

Blank lined paper for writing.

Blank lined paper for writing.

