



## Premium LCD line

spare part list

### N90

Front	2
Controls	22
Back	26

### N97

Front	4
Controls	22
Back	26

### N100

Front	6
Controls	22
Back	28

### N104

Front	8
Controls	22
Back	28

### N109

Front	10
Controls	22
Back	30

### N112

Front	12
Controls	22
Back	26

### N145

Front	14
Controls	22
Back	32

### N150

Front	16
Controls	22
Back	32

### N175

Front	18
Controls	22
Back	32

### N180

Front	20
Controls	24
Back	34

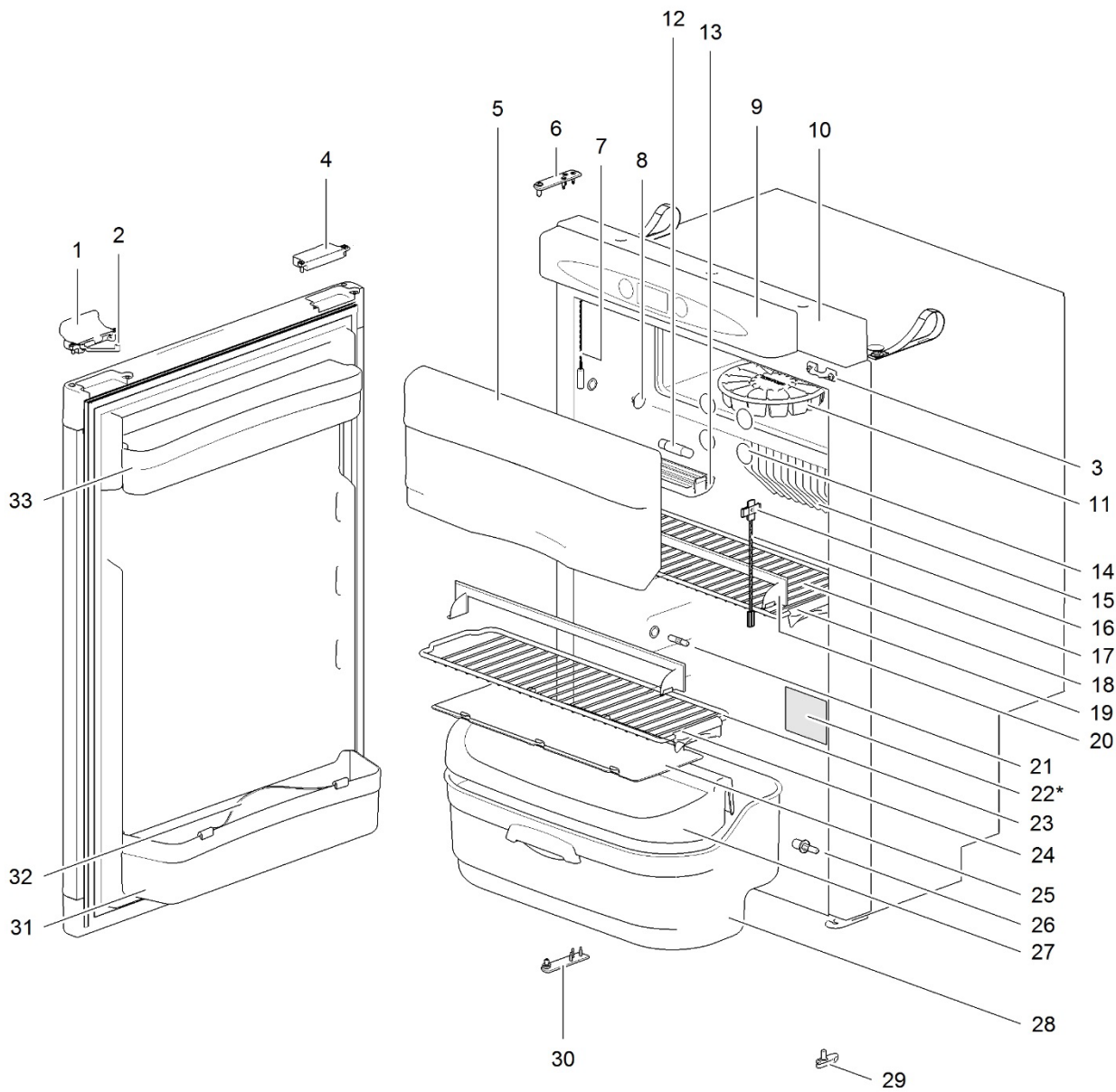

22\*



LE1085\_N90-front\_0614-V02

		Spare part number	Spare part number	Colours available
1	Latch		626985	27
2	Storage strap	626986		27
3	Strike plate			
4	Pocket cover			
5	Freezer door		690852	
	Hinge freezer door (2x)	624680		08
6	Hinge plate			
7	Interior light switch	623061		
8	Cap (2x)	623622		08
9	Control panel	Refer to page 22		
10	Mounting Box	Refer to page 22		
11	Ice cube tray			
12	Interior light bulb	624003		
13	Interior light cover	624002		
14	Cap freezer bolt (12x)	624479		08
15	Fin			
16	Fin clip (3x)	623059		
17	Thermistor	623077		
18	Shelf 455 x 163.9	623048		08
19	Clip shelf small	623626		08
20	Shelf food retainer	624456		08
21	Hinge pin			
22	Identification label *			
23	Shelf 455 x 118.2	623047		08
24	Clip shelf small	623626		08
25	Shelf tray insert 403 x 97.9	623634		12
26	Hinge pin			
27	Flip top cover	623615		
28	Vegetable bin	623617		
29	Latch bottom	624001		27
30	Hinge plate			
31	Door bin	690818		08
32	Bottle retainer	623042		12
33	Door bin	690817		08

\* With a request for information or service, always provide the serial number of the refrigerator. The serial number is the code below the barcode on the identification label.

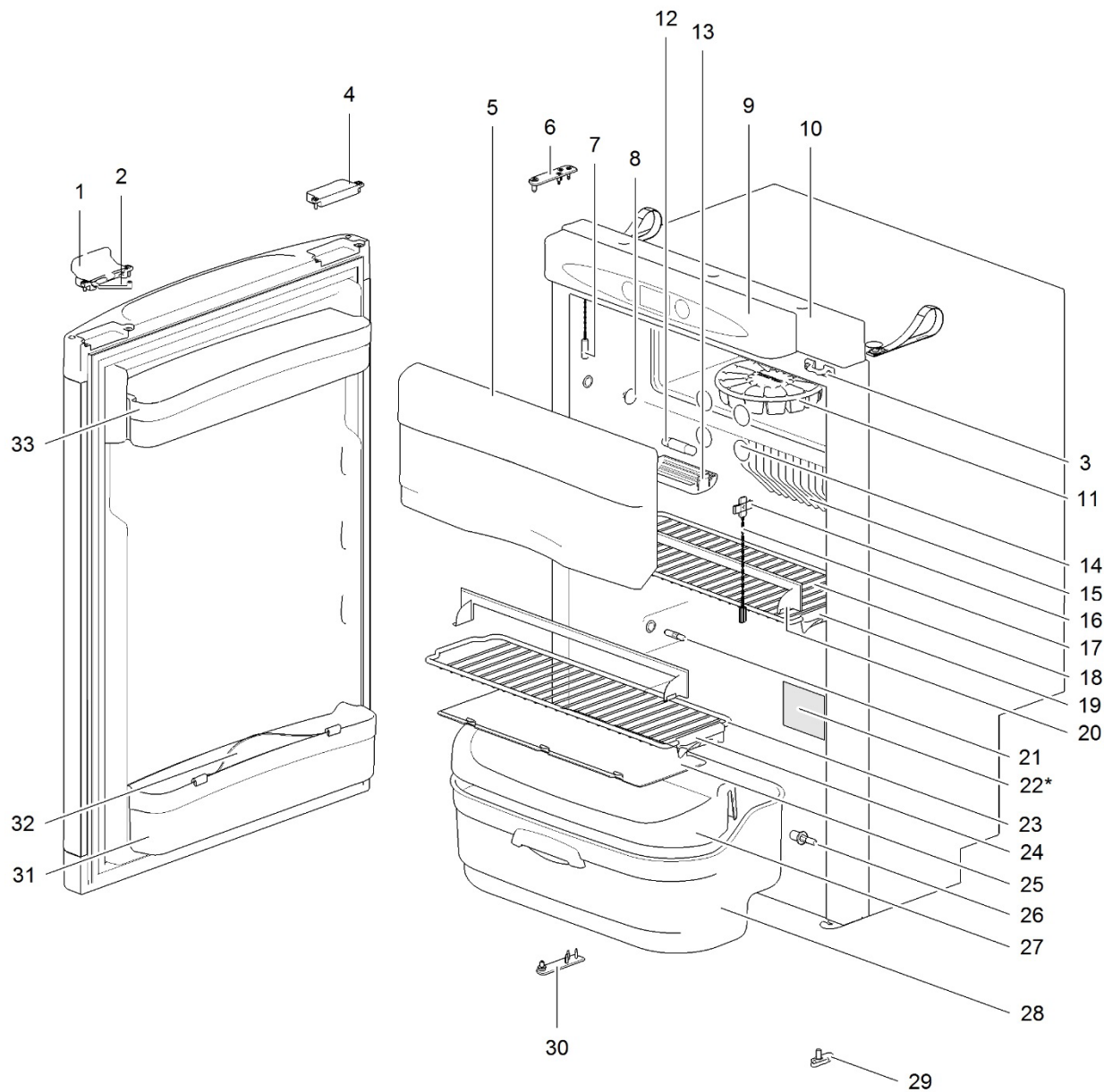

22\*



		Spare part number	Spare part number	Colours available
1	Latch		626985	27
2	Storage strap	626986		27
3	Strike plate			
4	Pocket cover			
5	Freezer door		690852	
	Hinge freezer door (2x)	624680		08
6	Hinge plate			
7	Interior light switch	623061		
8	Cap (2x)	623622		08
9	Control panel	Refer to page 22		
10	Mounting box	Refer to page 22		
11	Ice cube tray			
12	Interior light bulb	624003		
13	Interior light cover	624002		
14	Cap freezer bolt (12x)	624479		08
15	Fin			
16	Fin clip (3x)	623059		
17	Thermistor	623077		
18	Shelf 455 x 163.9	623048		08
19	Clip shelf small	623626		08
20	Shelf food retainer	624456		08
21	Hinge pin			
22	Identification label *			
23	Shelf 455 x 118.2	623047		08
24	Clip shelf small	623626		08
25	Shelf tray insert 403 x 97.9	623634		12
26	Hinge pin			
27	Flip top cover	623615		
28	Vegetable bin	623617		
29	Latch bottom	624001		27
30	Hinge plate			
31	Door bin			
32	Bottle retainer	623042		12
33	Door bin	624025		12

\* With a request for information or service, always provide the serial number of the refrigerator. The serial number is the code below the barcode on the identification label.



		Spare part number	Spare part number	Colours available
1	Latch		626985	27
2	Storage strap	626986		27
3	Strike plate			
4	Pocket cover			
5	Freezer door		690852	
	Hinge freezer door (2x)	624680		08
6	Hinge plate			
7	Interior light switch	623061		
8	Cap (2x)	623622		08
9	Control panel	Refer to page 22		
10	Mounting box	Refer to page 22		
11	Ice cube tray			
12	Cap freezer bolt (2x)	624479		08
13	Fin			
14	Interior light bulb	624003		
15	Interior light cover	624002		
16	Fin clip (3x)	623059		
17	Thermistor	623077		
18	Shelf 455 x 118.2	623047		08
19	Clip shelf small	623626		08
20	Identification label *			
21	Shelf 455 x 212.3	623055		08
22	Clip shelf large	623625		08
23	Shelf food retainer	624456		08
24	Shelf tray insert 403 x 192	623635		12
25	Hinge pin			
26	Flip top cover	623615		
27	Vegetable bin	623618		
28	Latch bottom	624001		27
29	Hinge plate			
30	Door bin	690818		08
31	Bottle retainer	623042		12
32	Door bin	690817		08

\* With a request for information or service, always provide the serial number of the refrigerator. The serial number is the code below the barcode on the identification label.





		Spare part number	Spare part number	Colours available
1	Latch		626985	27
2	Storage strap	626986		27
3	Strike plate			
4	Pocket cover			
5	Freezer door		690852	
	Hinge freezer door (2x)	624680		08
6	Hinge plate			
7	Interior light switch	623061		
8	Cap (2x)	623622		08
9	Control panel	Refer to page 22		
10	Mounting box	Refer to page 22		
11	Ice cube tray			
12	Cap freezer bolt (2x)	624479		08
13	Fin			
14	Interior light bulb	624003		
15	Interior light cover	624002		
16	Fin clip (3x)	623059		
17	Thermistor	623077		
18	Shelf 455 x 118.2	623047		08
19	Clip shelf small	623626		08
20	Identification label *			
21	Shelf 455 x 212.3	623055		08
22	Clip shelf large	623625		08
23	Shelf food retainer	624456		08
24	Shelf tray insert 403 x 192	623635		12
25	Hinge pin			
26	Flip top cover	623615		
27	Vegetable bin	623618		
28	Latch bottom	624001		27
29	Hinge plate			
30	Door bin			
31	Bottle retainer	623042		12
32	Door bin	624025		12

\* With a request for information or service, always provide the serial number of the refrigerator. The serial number is the code below the barcode on the identification label.

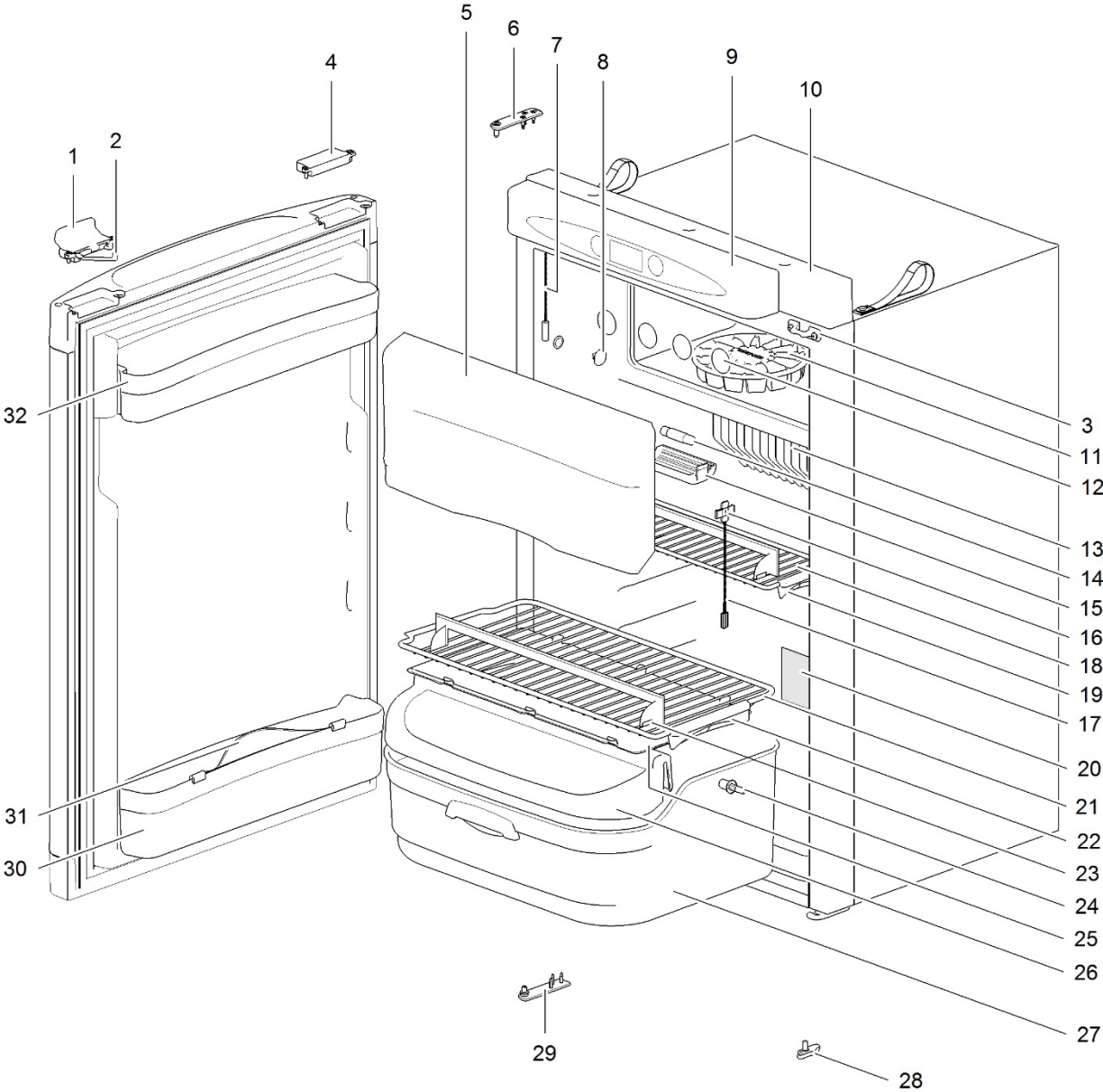

20\*

**TEUFELHAUPT**

Model No. \_\_\_\_\_ Type **G 11** **654** **CE**

Serial No. \_\_\_\_\_ Climate Class **52** **105**

230 VAC / 50 Hz / 150 W / 150 W / 12 VDC / 140 W

Gross Volume \_\_\_\_\_

Netto Volume \_\_\_\_\_

Volume Brutto \_\_\_\_\_

Volume Netto \_\_\_\_\_

Freezer Volume \_\_\_\_\_

Guaranteed Seal \_\_\_\_\_

Volume Comp. \_\_\_\_\_

Volume \_\_\_\_\_

Netto Volume \_\_\_\_\_

Netto Volume \_\_\_\_\_

Netto Volume \_\_\_\_\_

CE 0003 000007 Part No. 030007

ABSORBER: N103 = 154.5 g N103R04 = 15.1 g p. max = 21 bar

CPCH: NOFC, FREE / FWR, FWR / FWR

430019

8000, Serial of Regs, EUR

**ED13N1000611**

LE1091\_N109-front\_0614-V03

		Spare part number	Spare part number	Colours available
1	Latch		626985	27
2	Storage strap	626986		27
3	Strike plate			
4	Pocket cover			
5	Freezer door		690852	
	Hinge freezer door (2x)	624680		08
6	Hinge plate			
7	Interior light switch	623061		
8	Cap (2x)	623622		08
9	Control panel	Refer to page 22		
10	Mounting box	Refer to page 22		
11	Ice cube tray			
12	Cap freezer bolt (12x)	624479		08
13	Fin			
14	Interior light bulb	624003		
15	Interior light cover	624002		
16	Fin clip (3x)	623059		
17	Thermistor	623077		
18	Shelf 455 x 118.2	623047		08
19	Clip shelf small	623626		08
20	Identification label *			
21	Shelf 455 x 212.3	623055		08
22	Clip shelf large	623625		08
23	Shelf food retainer	624456		08
24	Shelf tray insert 403 x 192	623635		12
25	Hinge pin			
26	Flip top cover	623615		
27	Vegetable bin	623618		
28	Latch bottom	624001		27
29	Hinge plate			
30	Door bin			
31	Bottle retainer	623042		12
32	Door bin	624025		12

\* With a request for information or service, always provide the serial number of the refrigerator. The serial number is the code below the barcode on the identification label.

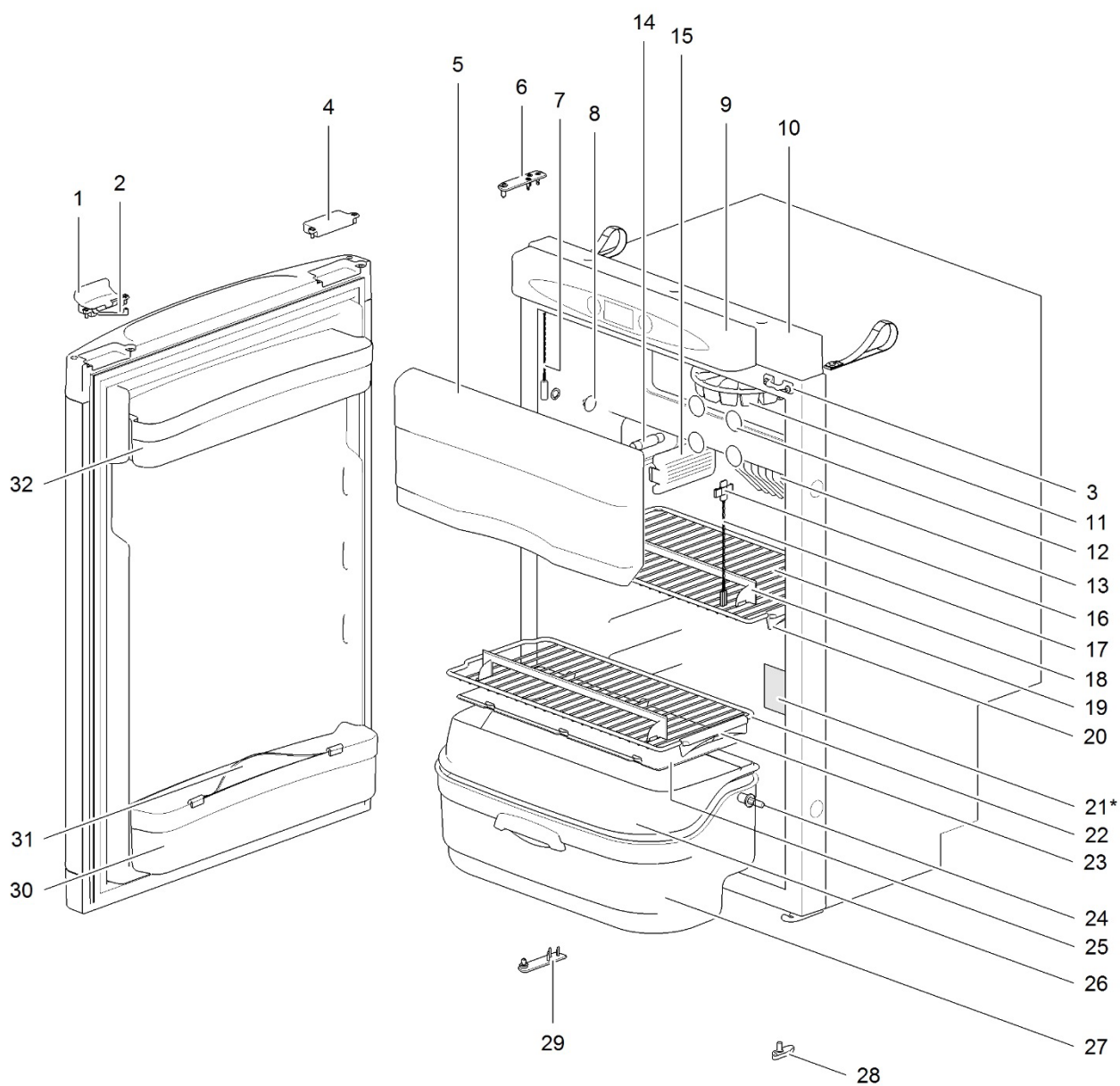

21\*



		Spare part number	Spare part number	Colours available
1	Latch		626985	27
2	Storage strap	626986		27
3	Strike plate			
4	Pocket cover			
5	Freezer door		690852	
	Hinge freezer door (2x)	624680		08
6	Hinge plate			
7	Interior light switch	623061		
8	Cap (2x)	623622		08
9	Control panel	Refer to page 22		
10	Mounting box	Refer to page 22		
11	Ice cube tray			
12	Cap freezer bolt (12x)	624479		08
13	Fin			
14	Interior light bulb	624003		
15	Interior light cover	624002		
16	Fin clip (3x)	623059		
17	Thermistor	623077		
18	Shelf 453.8 x 205	623051		08
19	Shelf food retainer	624456		08
20	Clip shelf small	623626		08
21	Identification label *			
22	Shelf 453.8 x 180	626643		08
23	Clip shelf large	623625		08
24	Hinge pin			
25	Shelf tray insert 403 x 192	623635		12
26	Top cover	626641		12
27	Vegetable bin	623617		
28	Latch bottom	624001		27
29	Hinge plate			
30	Door bin			
31	Bottle retainer	623042		12
32	Door bin	624025		12

\* With a request for information or service, always provide the serial number of the refrigerator. The serial number is the code below the barcode on the identification label.



		Spare part number	Spare part number	Colours available
1	Storage strap	626986	626985	27
2	Latch			27
3	Strike plate			
4	Interior light switch	623061		
5	Pocket cover			
6	Hinge center			
7	Hinge plate			
8	Cap (2x)	623622		08
9	Cap freezer bolt (12x)	624479		08
10	Shelf	623633		08
11	Ice cube tray			
12	Control panel	Refer to page 22		
13	Interior light bulb	624003		
14	Interior light cover	624002		
15	Fin			
16	Shelf 428.5 x 143.1	623044		08
17	Clip shelf large	623625		08
18	Fin clip (3x)	623059		
19	Thermistor	623077		
20	Shelf food retainer	624456		08
21	Identification label *			
22	Shelf 427.5 x 203.3	623045		08
23	Clip shelf large	623625		08
24	Shelf tray insert 371.3 x 183	623636		12
25	Flip top cover	623616		
26	Vegetable bin			
27	Hinge pin			
28	Latch bottom	624001		27
29	Hinge plate			
30	Door bin			
31	Bottle retainer	623042		12
32	Door bin	690804		08

\* With a request for information or service, always provide the serial number of the refrigerator. The serial number is the code below the barcode on the identification label.



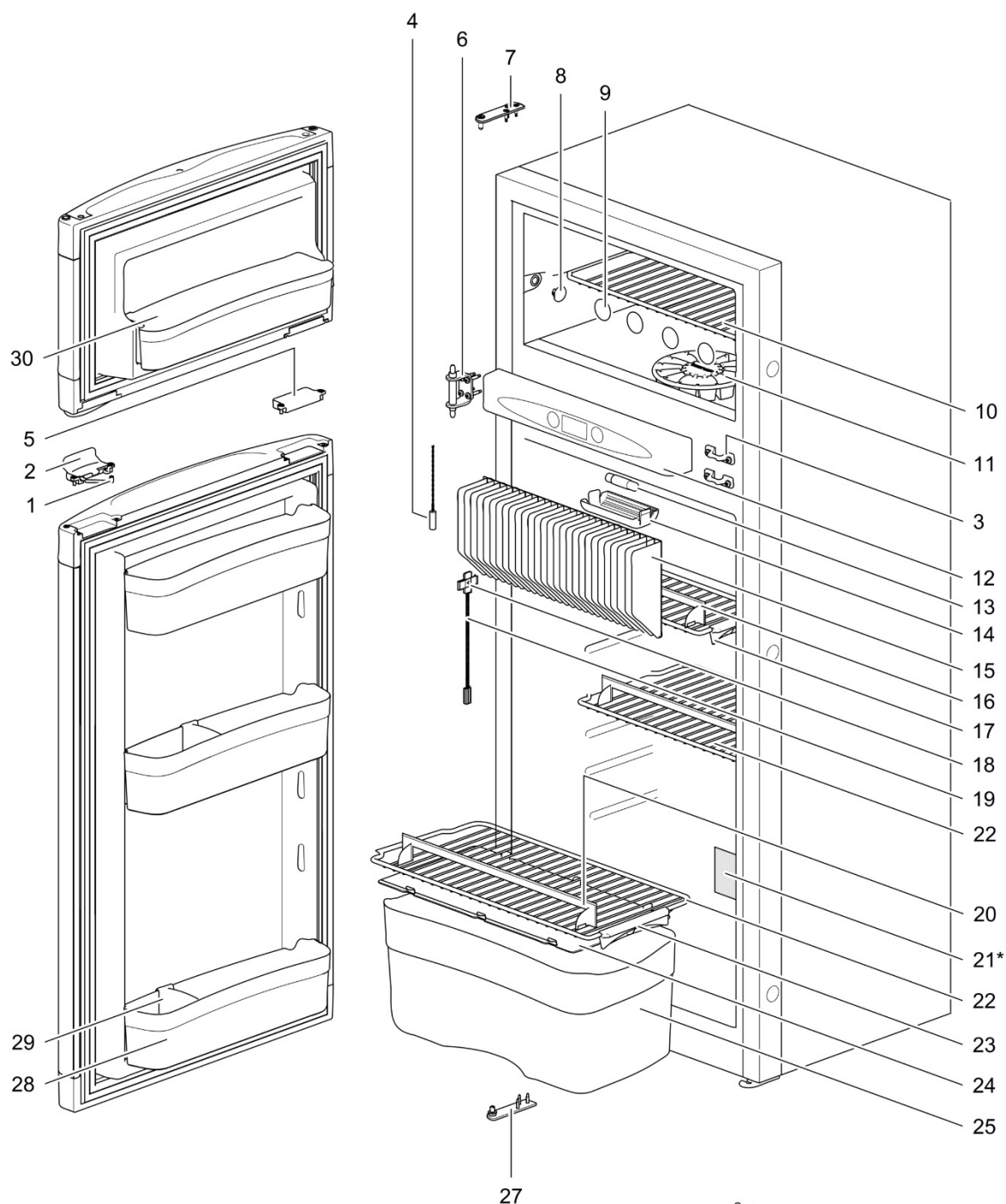

21\*

<b>Model No</b> Serie No		<b>Type</b> E11 Dimensie CLasse L 20	CE
250 Volt/50 Hz/2500 W/1450 W/12 VDC/1450 W		130112	
Grasso Volume Brutto Volume Volume Brutto Netto Volume	100 L 210 L 210 L 210 L	130112	
Primo Volume Grasso Volume Volume Netto Volume Netto		130112 130112 130112 130112	
Net Volume Volume Netto Netto Volume		130112 130112 130112	
CE 0003 EN10007		Part No. 020007	
ABSORBER 100 x 100 g		130112	
COP/MCFC FREE / FROST FREE		130112	

LE1094\_N150-front\_1214-V05



		Spare part number	Spare part number	Colours available
1	Storage strap	626986	626985	27
2	Latch			27
3	Strike plate			
4	Interior light switch	623061		
5	Pocket cover			
6	Hinge center			
7	Hinge plate			
8	Cap (2x)	623622		08
9	Cap freezer bolt (12x)	624479		08
10	Shelf	623633		08
11	Ice cube tray			
12	Control panel	Refer to page 22		
13	Interior light bulb	624003		
14	Interior light cover	624002		
15	Fin			
16	Shelf 428.5 x 172	626978		08
17	Clip shelf large	623625		08
18	Fin clip (3x)	623059		
19	Thermistor	623077		
20	Shelf food retainer	624457		08
21	Identification label *			
22	Shelf 428.4 x 232.3	626979		08
23	Clip shelf large	623625		08
24	Shelf tray insert 371.25 x 212	626981		12
25	Vegetable bin	626980		12
26	Latch bottom	624001		27
27	Hinge plate			
28	Door bin	626976		12
29	Bottle retainer	626989		12
30	Door bin	626977		12

\* With a request for information or service, always provide the serial number of the refrigerator. The serial number is the code below the barcode on the identification label.

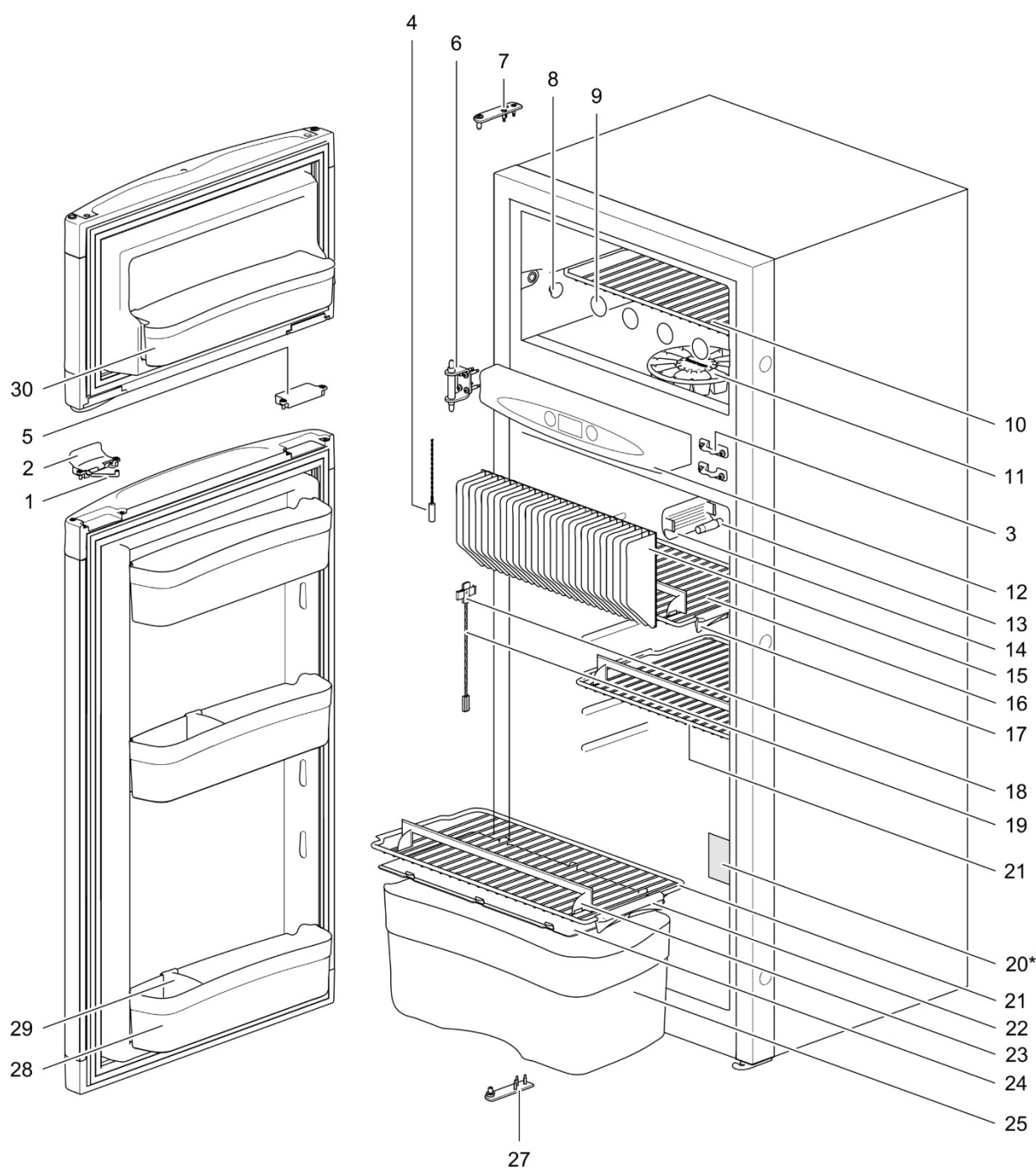

29\*



LE1095\_N175-front\_0614-V04

		Spare part number	Spare part number	Colours available
1	Storage strap	626986	626985	27
2	Latch			27
3	Strike plate			
4	Interior light switch	623061		
5	Pocket cover			
6	Hinge center			
7	Hinge plate			
8	Cap (2x)	623622		08
9	Cap freezer bolt (12x)	624479		08
10	Shelf 404 x 238.5	631741		08
11	Ice cube tray			
12	Control panel	Refer to page 22		
13	Interior light bulb	624003		
14	Interior light cover	624002		
15	Fin			
16	Shelf 428.4 x 232.3	626979		08
17	Clip shelf large	623625		08
18	Fin clip (3x)	623059		
19	Thermistor	623077		
20	Identification label *			
21	Shelf 428.4 x 282.3	631743		08
22	Clip shelf large	623625		08
23	Shelf food retainer	624457		08
24	Shelf tray insert 371.25 x 212	626981		12
25	Vegetable bin	690829		08
26	Latch bottom	624001		27
27	Hinge plate			
28	Door bin	626976		12
29	Bottle retainer	626989		12
30	Door bin	626977		12

\* With a request for information or service, always provide the serial number of the refrigerator. The serial number is the code below the barcode on the identification label.

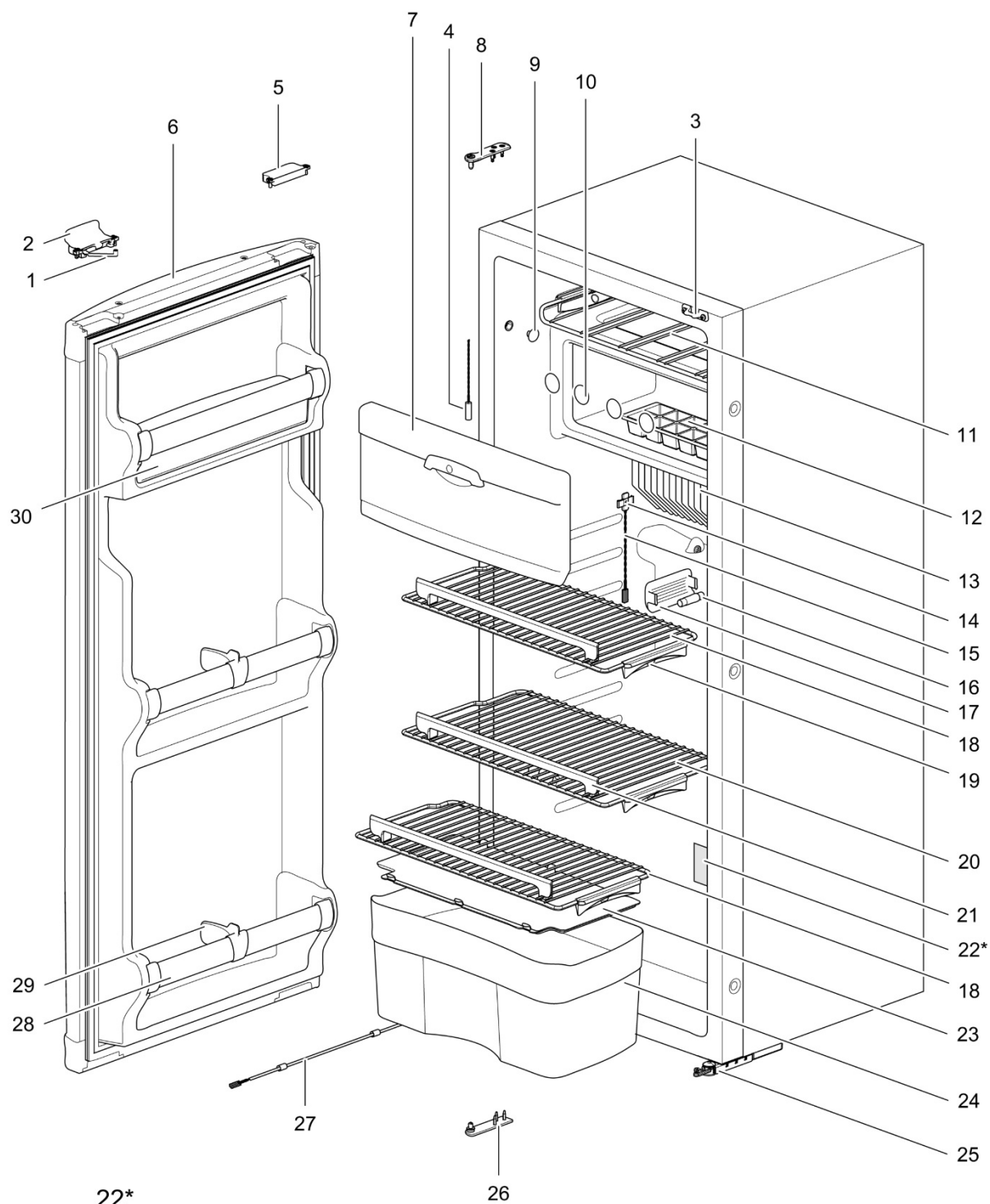

		Spare part number	Spare part number	Colours available
1	Storage strap	626986	626985	27
2	Latch			27
3	Strike plate			
4	Interior light switch	623061		
5	Pocket cover			
6	Control panel	<i>Refer to page 24</i>		
7	Freezer door		690852	
	Hinge freezer door (2x)	624680		08
8	Hinge plate			
9	Cap (2x)	623622		08
10	Cap freezer bolt (12x)	624479		08
11	Shelf bottle	629725		08
12	Ice cube tray			
13	Fin			
14	Fin clip (3x)	623059		
15	Thermistor	623077		
16	Interior light bulb	624003		
17	Interior light cover	624002		
18	Shelf 453 x 212.3	629726		08
19	Clip shelf large	623625		08
20	Shelf 453 x 258.8	629727		08
21	Shelf food retainer	624456		08
22	Identification label *			
23	Shelf tray insert 371.25 x 212	626981		12
24	Vegetable bin	626980		12
25	Latch bottom	629721		
26	Hinge plate			
27	Flexible cable	<del>629723</del>		
28	Door rail			
29	Bottle retainer	626989		12
30	Door bin	629719		08

\* With a request for information or service, always provide the serial number of the refrigerator. The serial number is the code below the barcode on the identification label.

~~xxxxxx~~ = not available anymore

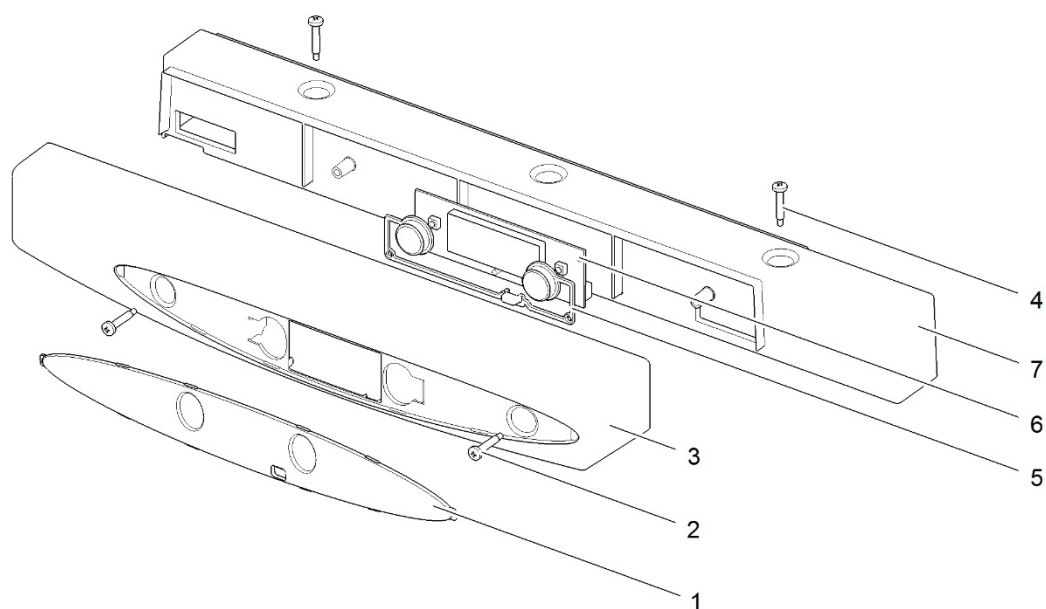
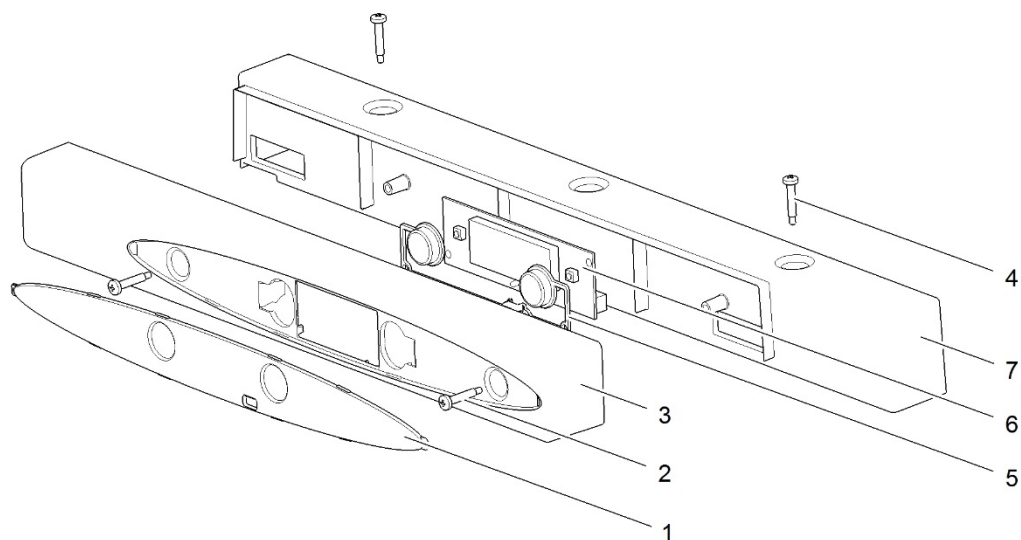

		Spare part number	Spare part number	Colours available
1	Overlay	626975		
2	Screw			
3	Control panel			
	Flat	<del>626974</del>		<del>07, 27</del>
	Curved	626973		<del>07, 27</del>
4	Screw			
5	Push buttons			
6	Display board LCD	626972		
7	Mounting box (not for N145, N150 and N175)			

~~xxxxx~~\* = not available anymore

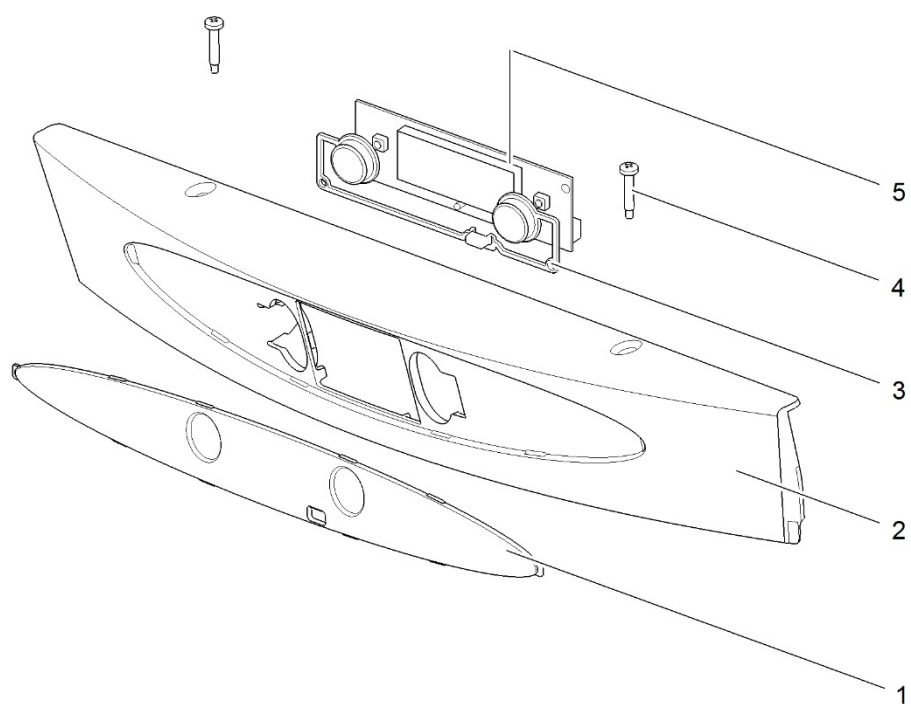



		Spare part number	Spare part number	Colours available
1	Overlay	626975		
2	Control panel	629720		07
3	Push buttons			
4	Screw			
5	Display board LCD	626972		

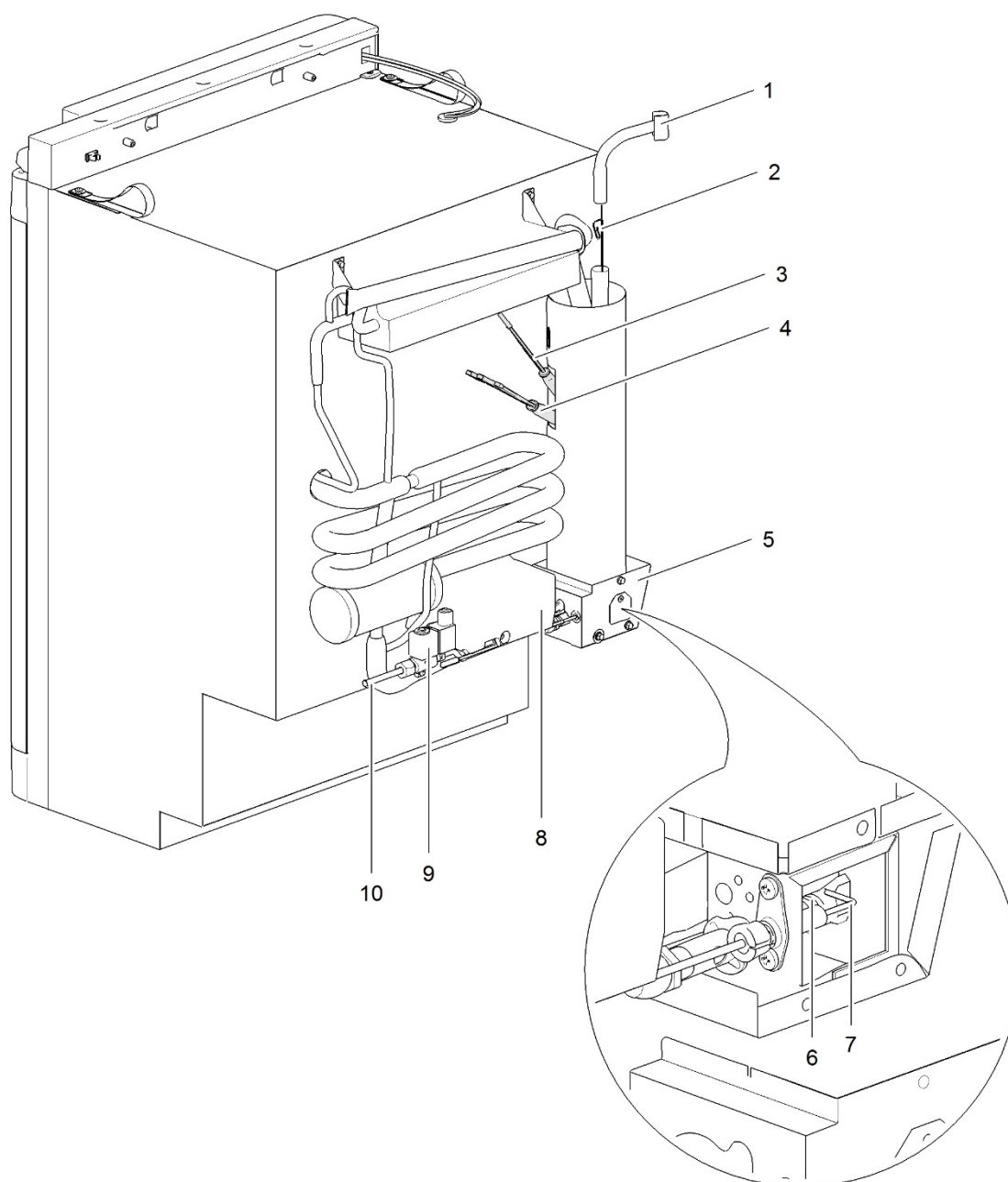

LE1097\_N90-N97-N112-back\_0913-V01

		Spare part number	Spare part number	Colours available
1	Flue exhaust			
	Short	627008		
	Long	624480		
2	Heat diffuser			
3	Heater AC			
	< 12/05/2009 (E132K.....)	626994		
	≥ 12/05/2009 (E132K.....)	633575		
4	Heater DC			
	< 12/05/2009 (E132K.....)	not available		
	≥ 12/05/2009 (E132K.....)	633574		
5	Heater box			
6	Burner assembly			
	< 01/11/2011 (E305M.....)	623019		
	≥ 01/11/2011 (E305M.....)	634570		
7	Spark electrode	626988		
8	Power control board			
	Electric	691136		
	Automatic	691137		
9	Gas valve			
	< 25/09/2006 (E268F.....)	631249		
	≥ 25/09/2006 (E268F.....)	630440		
10	Gas pipe			

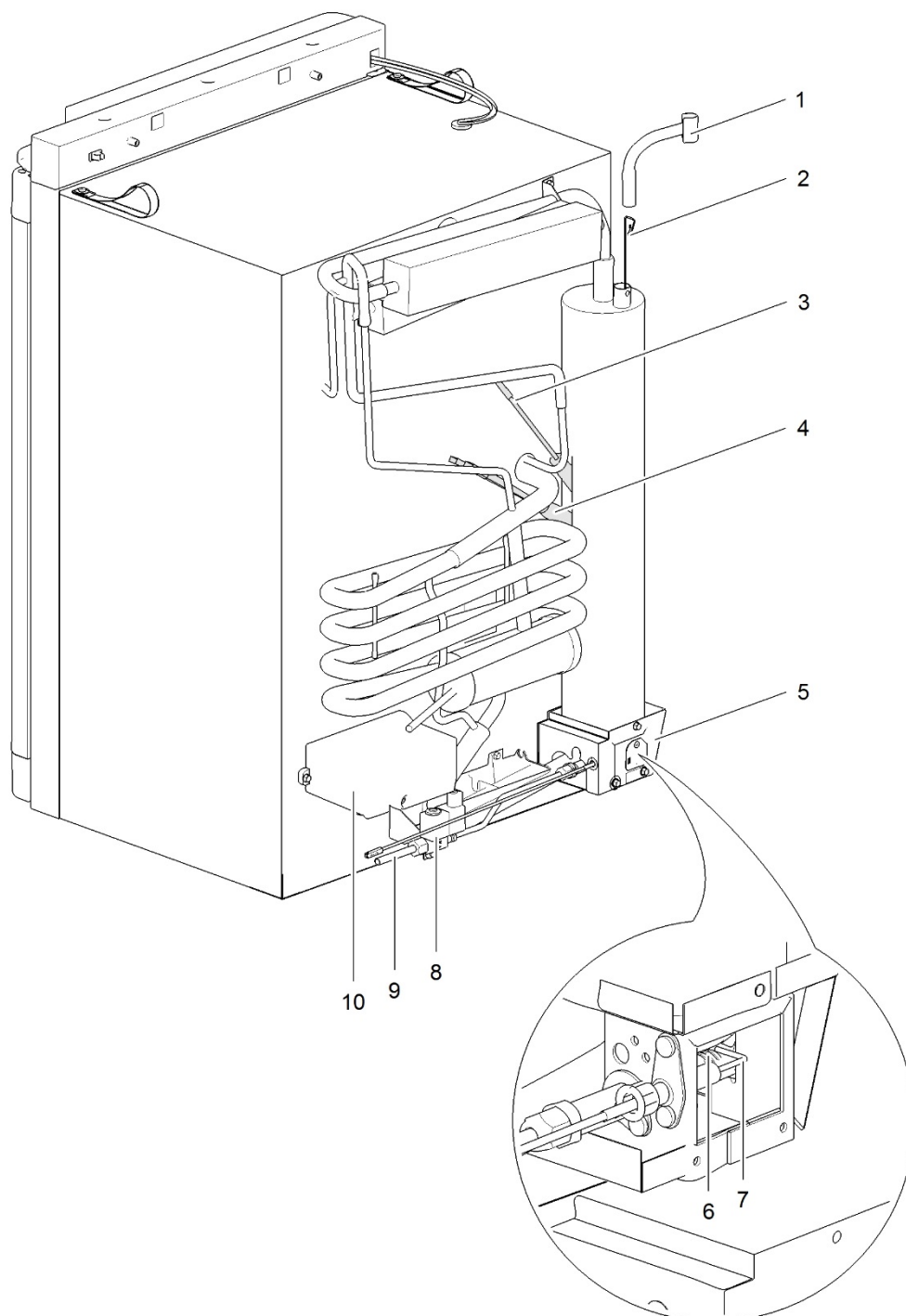

		Spare part number	Spare part number	Colours available
1	Flue exhaust			
	Short	627008		
	Long	624480		
2	Heat diffuser			
3	Heater AC			
	< 02/07/2009 (E183K.....)	626994		
	≥ 02/07/2009 (E183K.....)	633575		
4	Heater DC			
	< 02/07/2009 (E183K.....)	not available		
	≥ 02/07/2009 (E183K.....)	633574		
5	Heater box			
6	Burner assembly	623019		
7	Spark electrode	631736		
8	Gas valve			
	< 27/09/2006 (E270F.....)	631248		
	≥ 27/09/2006 (E270F.....)	630440		
9	Gas pipe			
10	Power control board			
	Electric	691136		
	Automatic	691137		

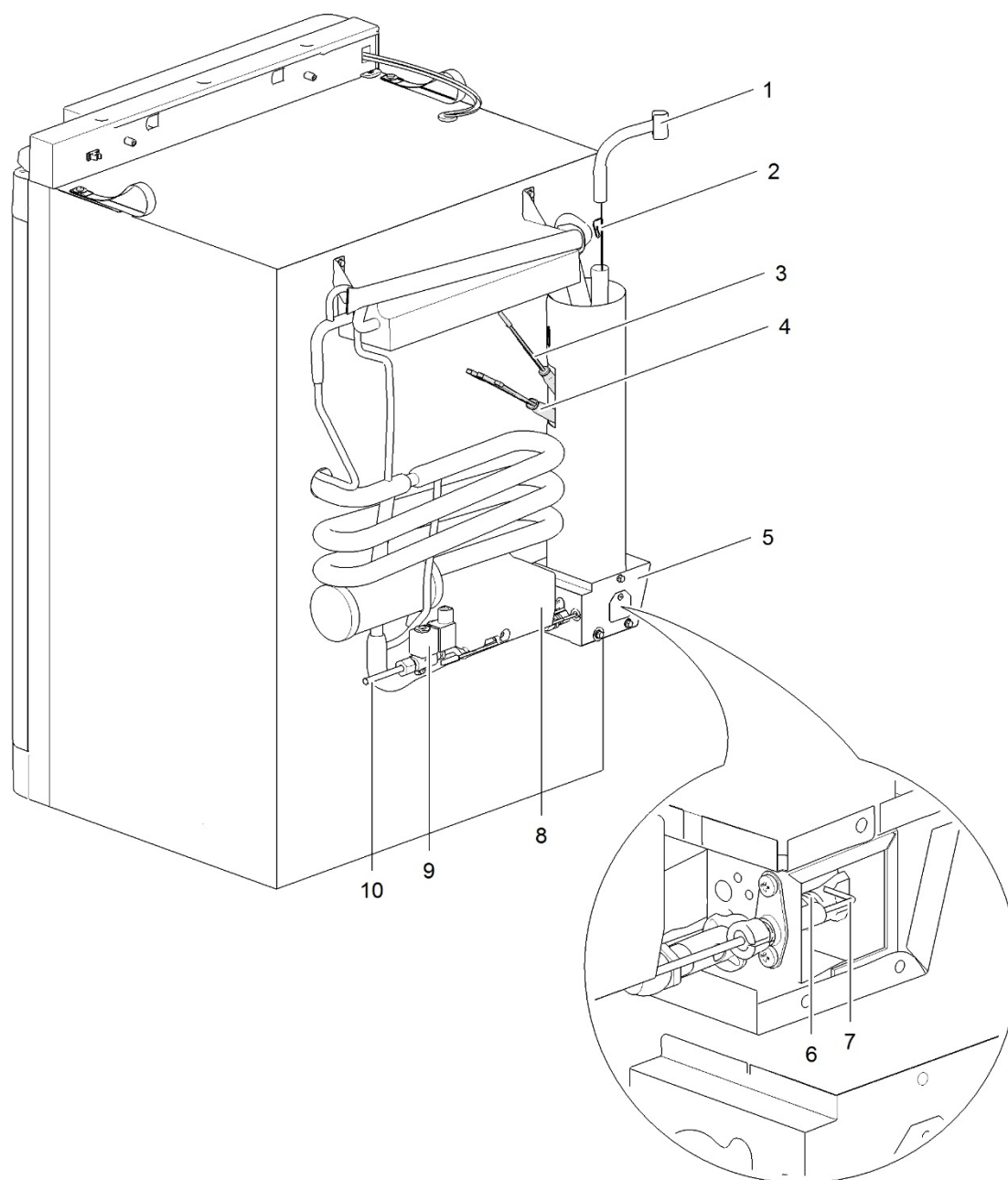

		Spare part number	Spare part number	Colours available
1	Flue exhaust			
	Short	627008		
	Long	624480		
2	Heat diffuser			
3	Heater AC	626994		
4	Heater DC	not available		
5	Heater box			
6	Burner assembly	623019		
7	Spark electrode	626988		
8	Power control board			
	Electric	691136		
	Automatic	691137		
9	Gas valve			
	< 25/09/2006 (E268F.....)	631249		
	≥ 25/09/2006 (E268F.....)	630440		
10	Gas pipe			

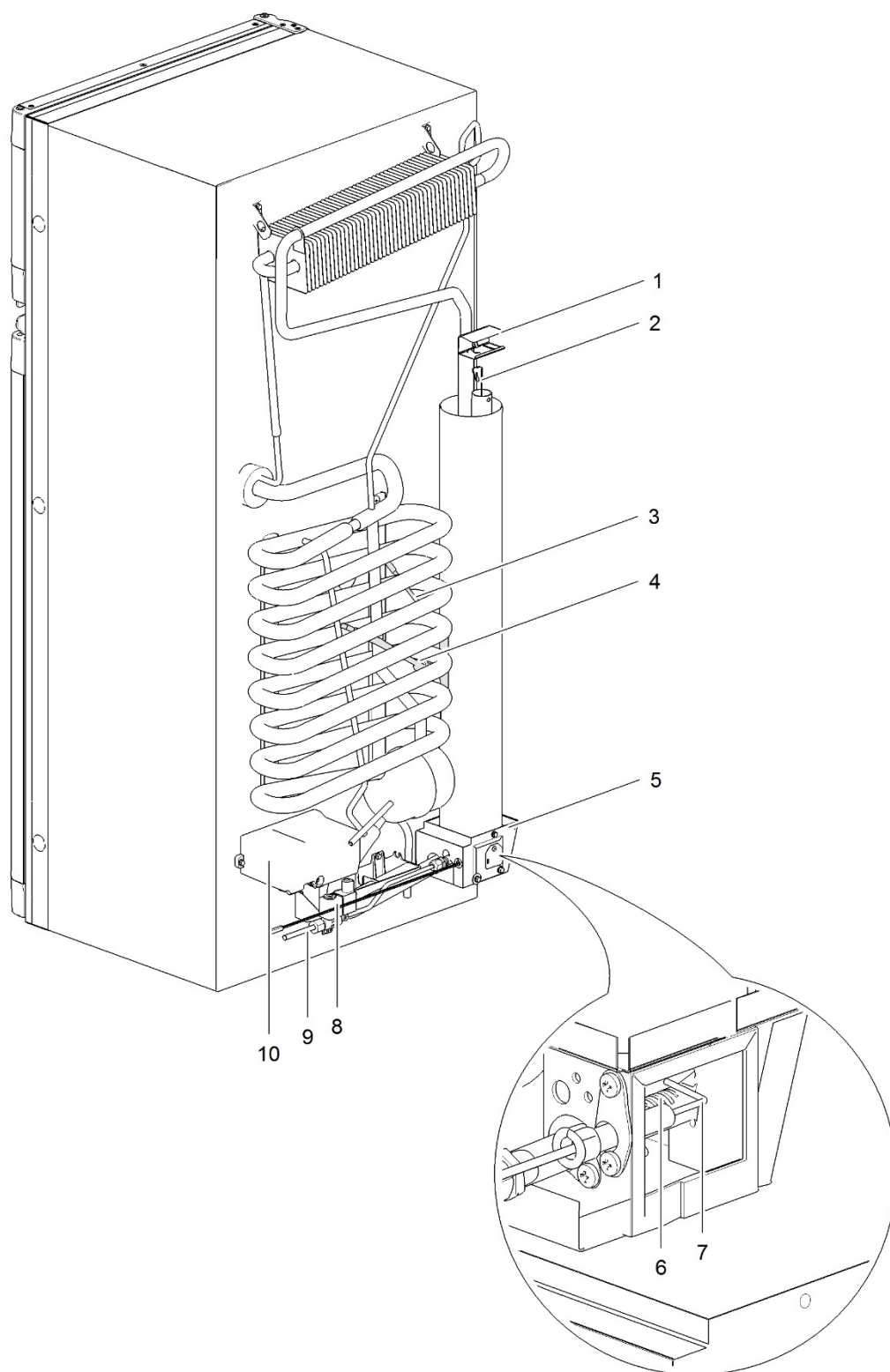

LE1101\_N145-N150-back\_0913-V01



		Spare part number	Spare part number	Colours available
1	Heat cap	690839		
2	Heat diffuser			
3	Heater AC			
	< 28/05/2009 (E148K.....)	626992		
	≥ 28/05/2009 (E148K.....)	633573		
4	Heater DC			
	< 05/12/2007 (E339G.....)	626993		
	05/12/2007 - 28/05/2009	631752		
	≥ 28/05/2009 (E148K.....)	633572		
5	Heater box			
6	Burner assembly	623058		
7	Spark electrode	626987		
8	Gas valve			
	< 27/09/2006 (E270F.....)	631248		
	≥ 27/09/2006 (E270F.....)	630440		
9	Gas pipe			
10	Power control board			
	Electric	691136		
	Automatic	691137		

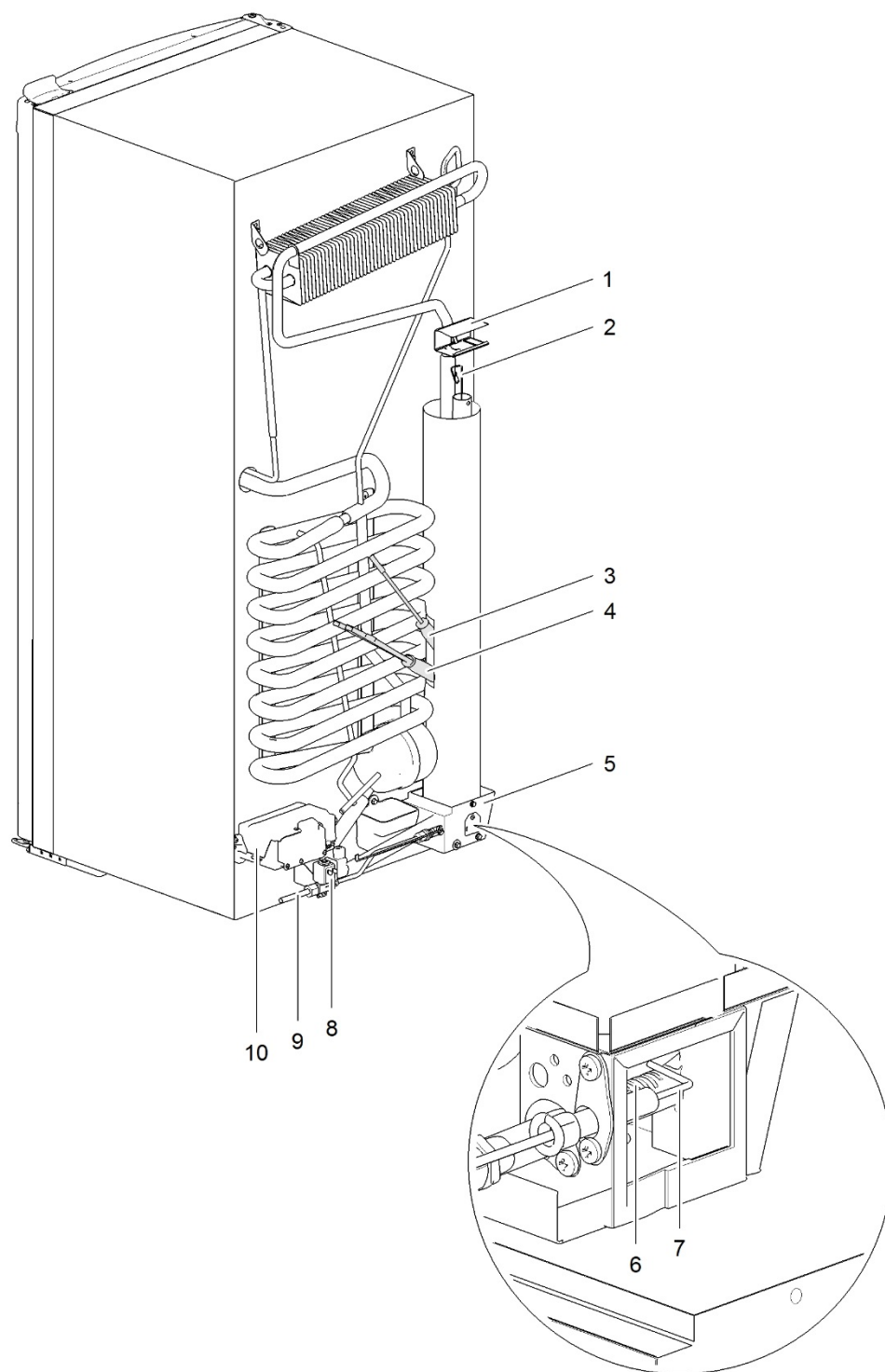

		Spare part number	Spare part number	Colours available
1	Heat cap	690839		
2	Heat diffuser			
3	Heater AC			
	< 28/05/2009 (E148K.....)	626992		
	≥ 28/05/2009 (E148K.....)	633573		
4	Heater DC			
	< 05/12/2007 (E339G.....)	626993		
	05/12/2007 - 28/05/2009	631752		
	≥ 28/05/2009 (E148K.....)	633572		
5	Heater box			
6	Burner assembly	623058		
7	Spark electrode	626987		
8	Gas valve			
	< 27/09/2006 (E270F.....)	631248		
	≥ 27/09/2006 (E270F.....)	630440		
9	Gas pipe			
10	Power control board			
	Electric	691136		
	Automatic	691137		

Colour Numbers	Description	Colour reference
07	Traffic Grey	RAL 7042
08	White	MP 1013 MP FR 85 R7
12	Blue	RAL 5012
27(R)	Black	RAL 9005
30	Mocha	NCS S 2005-Y40R
90	Anthracite Grey	RAL 7016
136	Black Grey	RAL 7021
138R	Piano Black	AM50CI EG schwarz 8325 VA 82-99139/10